

PARENT PARCEL: 06-25-037-103-003

NO. 22524-X

CHILD PARCEL:

STARTING POINT: S/L 37 in O.L. 37, Block 103 in Dilworth's East Elyria Subdivision

DEPTH CORRECTION

S/L 37
-003
~~45 X 132~~ CORRECTION
45 X 140 PER DEED

PRIOR INSTRUMENT

-003 OR 1171/340
Vacated Alley DV 537/243



Dilworth's East Elyria Subd.

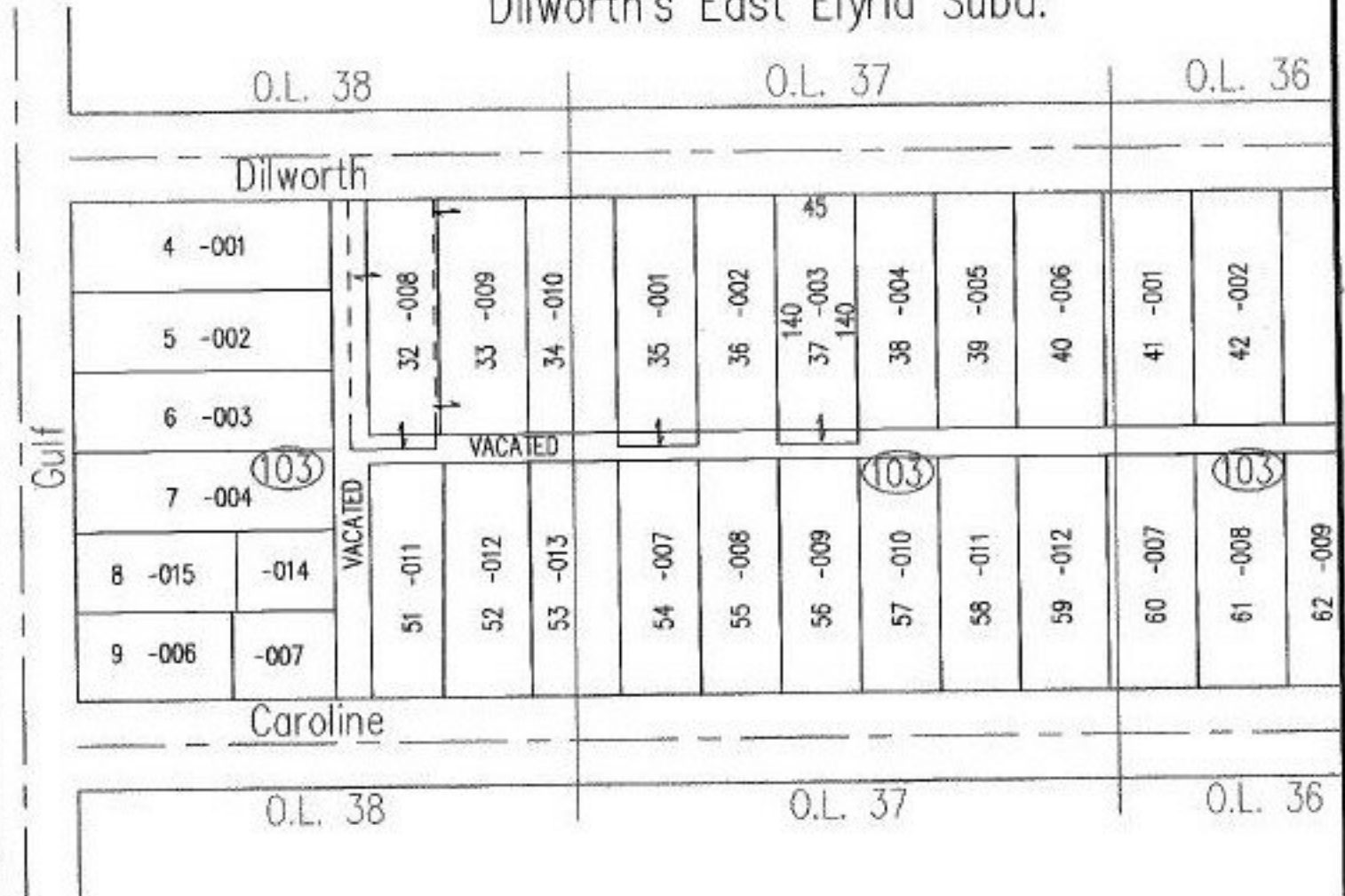

SPLITS/DEEDS PROCESSED
LORAIN COUNTY TAX MAP DEPARTMENT
226 MIDDLE AVE. ELYRIA, OHIO

SURVEYED BY: _____
CLOSURE: N/A
MAP PAGE(S): 6-86
APPROVED BY: kac DATE: 4/17/98
SCALE: 1" = 100' PRIOR INSTRUMENT: OR 1171/340