

#22495-D

PARENT PARCEL: 15-00-046-104-008, 009

NO. 22495-D

CHILD PARCEL:

STARTING POINT: SW corner of S/A 1

TAX MAP SHOWS:

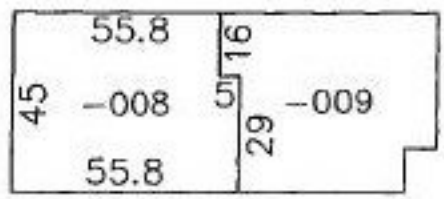

DV 714/241
DV 974/968

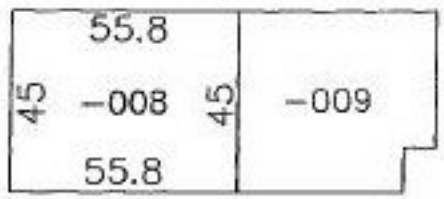

DV 714/243
DV 714/247

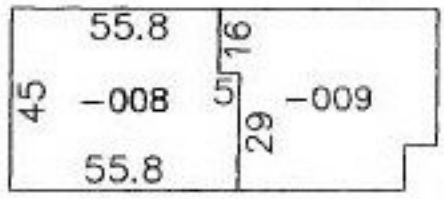

DV 298/227
DV 1031/878
DV 1189/936

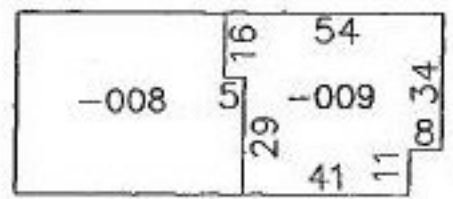

CORRECT TAX MAP TO THIS:

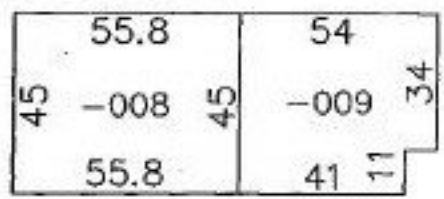

CORR. PER DEEDS:

DV 714/241
DV 974/968

-008 55.80 X 45
-009 41 X 45 IRREG.



SPLITS/DEEDS PROCESSED
LORAIN COUNTY TAX MAP DEPARTMENT
226 MIDDLE AVE. ELYRIA, OHIO

SURVEYED BY: _____
CLOSURE: 0.00:10.000
MAP PAGE(S): 15-00-046-A *6-24-98*
APPROVED BY: *kac* DATE: *8/23/86*
SCALE: 1" = 100' PRIOR INSTRUMENT: DV 1189/936