

PARENT PARCEL: ADD TO DUPLICATE

CHILD PARCEL: 04-00-019-640-005

STARTING POINT: S.E. CORNER OF S/L 19

NO. 22387

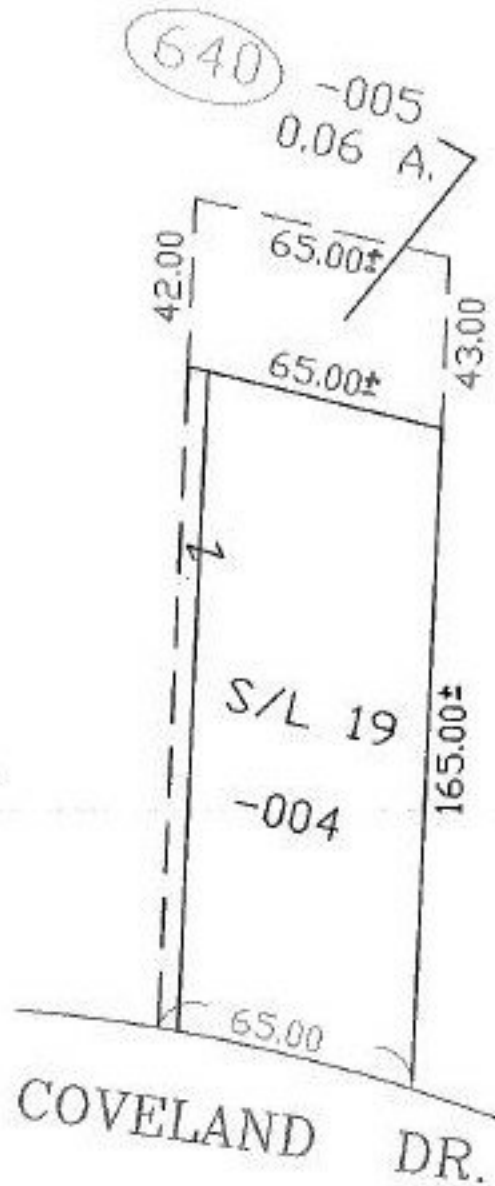

**SPLITS/DEEDS PROCESSED**

LORAIN COUNTY TAX MAP DEPARTMENT  
226 MIDDLE AVE. ELYRIA, OHIO

SURVEYED BY: GARRETT & ASSOC.

CLOSURE: NA

MAP PAGE(S): 4-00-019-C

APPROVED BY: J.S. T. MCNAB DATE: 3/11/05

SCALE: 1" = 100' PRIOR INSTRUMENT: DV XXXX/XXX