

PARENT PARCEL: 09-00-086-104-010, 011

CHILD PARCEL: 09-00-086-104-012

STARTING POINT:

NO. 22357-U

#22245-U was an uncombination
-001 was uncombined into -010, 011
#22357-U is to undo that uncomb.
uncomb. can't happen because building
lies on -010 and -011

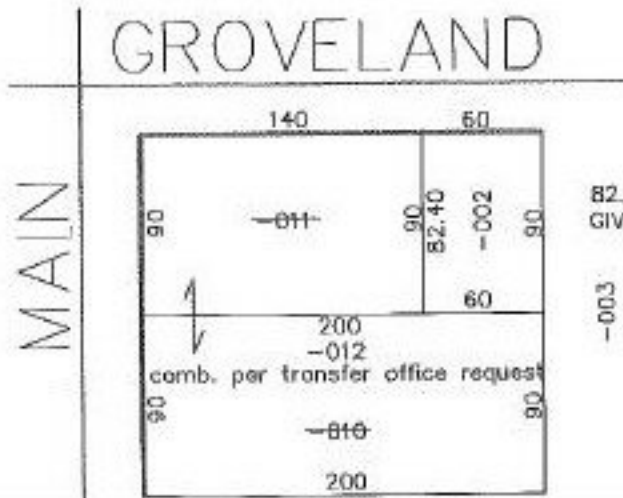

82.40 IS FROM DEED, OUR MAP
GIVES A DISTANCE OF 90.

DV 790/598 DV 1234/487
2/8/61 5/18/79

DV 1249/438 OR 693/88
11/7/79 4/23/93

OR 1207/152
1/19/96



SPLITS/DEEDS PROCESSED
LORAIN COUNTY TAX MAP DEPARTMENT
226 MIDDLE AVE. ELYRIA, OHIO

PRIOR INSTRUMENT: OR 693/88, OR 1207/152

CLOSURE:

MAP PAGE(S): 09-00-086-A

APPROVED BY: KAC DATE: 12/8/97

SCALE: 1" = 100'