

NUMBERED IN O.L. 10
MOVE NUMBER WOODFORD
SOUTH OF O.L. LINE

AVE.

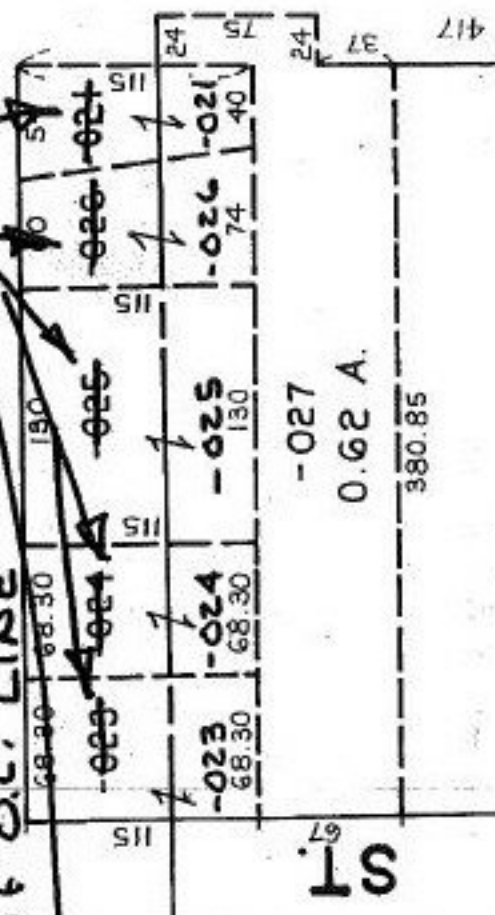

MAP
CORR.
ONLY

-003
12.33 A.

10

626.70

1067.06

300

101

340.69

1496.65

1035.35 D.
1075.35

516.50 D.

875.89

539.22

-027
0.62 A.
380.85

#21811X
PT. -029
PT. 13.27 A
#21811-X

APPROVED
LORAIN CO.
MAP DEPT.
DATE 8-23-96
PAGE 6-116
BY <i>[Signature]</i>
VOID AFTER 21811X

102

06-24-010-102

6-116

N