

of BANKS ROAD & INDIAN HOLLOW ROAD

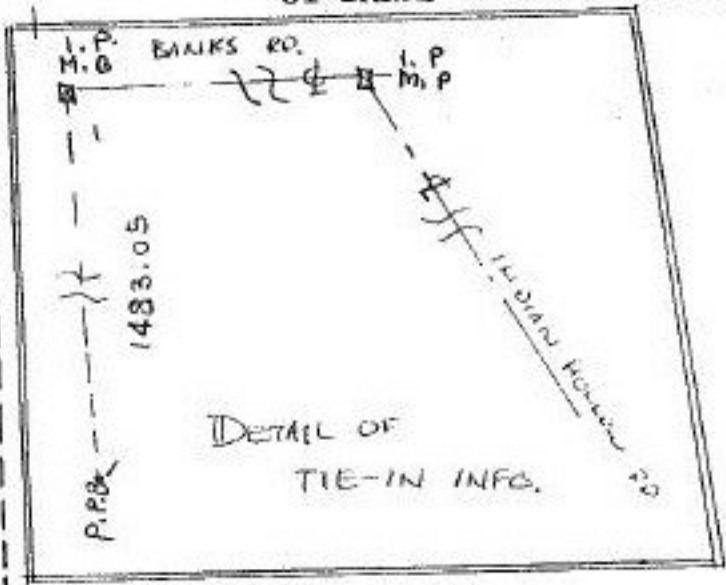

- 162
 PT - 012
 PT. 114.00A
 112.62A

P.P.NO. 10-00-024-000-
 PRIOR INST: DV. 1227/
 590

21502

APPROVED LORAIN CO. MAP DEPT
DATE 9-27-95
PAGE 10-00-024-C
BY CAROLYN FRANCIS
21502

1877.20
 1483.05