

251.73

48 - 007
3.931 A.

680.98

111.67
WOOSTER-AVON
LAKE RD.

251.59
111.67

COMBINATION

16-00-036-105 - 005 0.55A
- 006 1.45A
- 007 2.00A

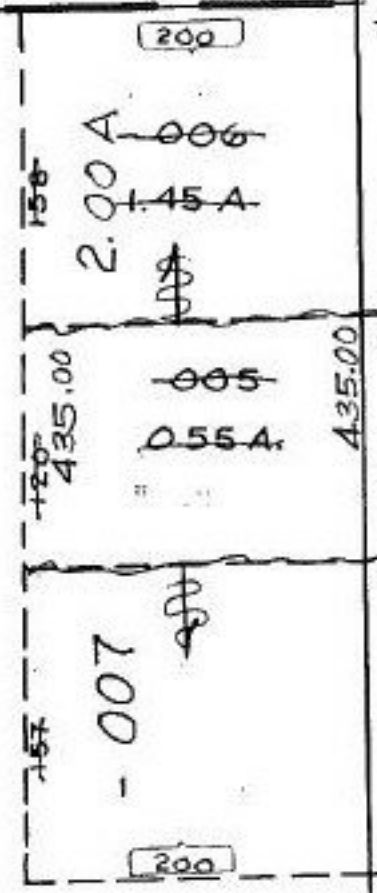

COMBINATION

WOOSTER - AVON LAKE ROAD

P.P.NO. 16-00-036-105
 PRIOR INST: 1117/77
 CLOSURE: 1:INF.
 SURVEYED BY: ROGER SIMON
 LAUNDON, SIMON, CAHL & ASOC.

21477

APPROVED LORAIN CO. MAP DEPT
DATE 9-7-95
PAGE 16-00-036-B
BY CAROLYN FRANCIS
21477