

EAST RIVER RD

21461

SEE 10-00-005-G

EAST RIVER ROAD

485.00

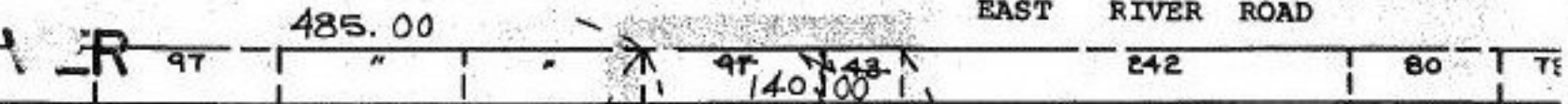

774.64

-001  
1.67 A.

719.21

-002  
1.56 A.  
672.20

-003  
1.51 A.

669.70

-011

-004  
1.46 A.

2.07A.

625.74  
674.54

-0.61A.

619.54

-009

-010  
5.39 A.

-004 1.46A

-009 0.61A

2.07A

COMBINATION  
10/5

104 A  
570

BRANCH

87.00  
211.42

43.31

48.31

156.00

-001  
4.02 A.

P.P. NO 10-00-006-105  
PRIOR INST  
757/189  
1286/560

21461

APPROVED LORAIN CO. MAP DEPT
DATE 8-23-95
PAGE 10-00-006C
BY CAROLYN FRANCIS
21461