

1452

1005.95

30.19  
14.60

73.53

95



93 - 019

-013

017

244.44 A.

243.13 A

242.13 A

27.00  
 45.00  
 682.00  
 400.00  
 282.00

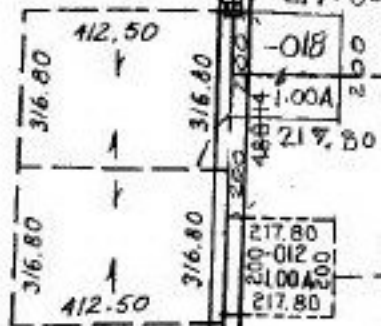

P.P. NO. 05-00-093-000  
 PRIOR INST: O.R. 635/750  
 CLOSURE:  
 SURVEYED BY: KS ASSOC.

QUARRY 174.82

APPROVED  
LORAIN CO.  
MAP DEPT

DATE 12-14-94

PAGE 5-E

BY CAROLYN  
FRANCIS

21165

-018

176.68 A.

92

1510.98

110.45

