

SEE 4-00-015-H

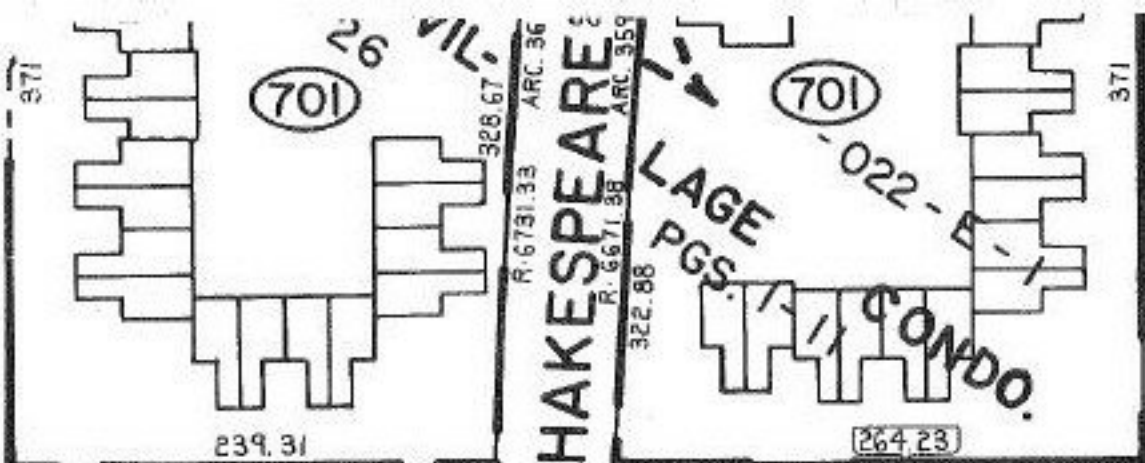

R = 6731.33
A = 34.85
CH 34.85

R = 6671.38
A = 37.42
CH 37.42

P.P. NO. 04-00-022-103-
PRIOR INST: O.R. 730/267
COMB. O.R. 892/276
CLOSURE: 1.14ac 1:INF
0.61ac 1:271,550 COMB.
22.92 ac. 1:254,232
SURVEYED BY: JOHN HANCOCK
REG. SURVEYOR

REF. LINE 1422.23

103

COMBINATION

1893.61

20.212

1428.07

- 047
044
21.78 A
22.92 A

4-24-95

21054

APPROVED LORAIN CO. MAP DEPT	
DATE	9-29-94
PAGE	4-00-012E
BY	CAROLYN FRANCIS
21054	