

50.87A - 008
1.38 A SMT
49.49 REM.

SEE 6-143

CO. COMM RES
68-

ELYRIA CITY CORP LINE 7

1011.78

ORD # 68-152

Pt. -008- 314

Pt. 50.87A.

49.49A

CARLISLE
O.L. 5

34

CARLISLE TWP

10-00-005-102

8/19/94
20930

APPROVED	
LORAIN CO.	
MAP DEPT.	
DATE	7-8-94
PAGE	1000005-C
BY	CAROLYN FRANCIS
VOID AFTER	# 20930

P.P.NO. 10-00-005-102-
PRIOR INST: O.R.340/213

-027
12.46 A.

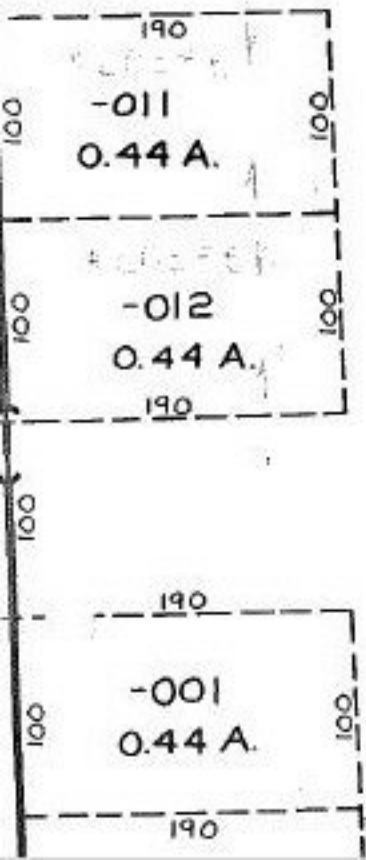

-2
9.6