

SEE 4-0-024-  
FROM INTERSECTION  
OF N.W. 1/4 SEC. 10, T. 25 N. AND  
R. 10 W.

RD. - 1860.15

825 LEAK RD. (200.26)

423.84

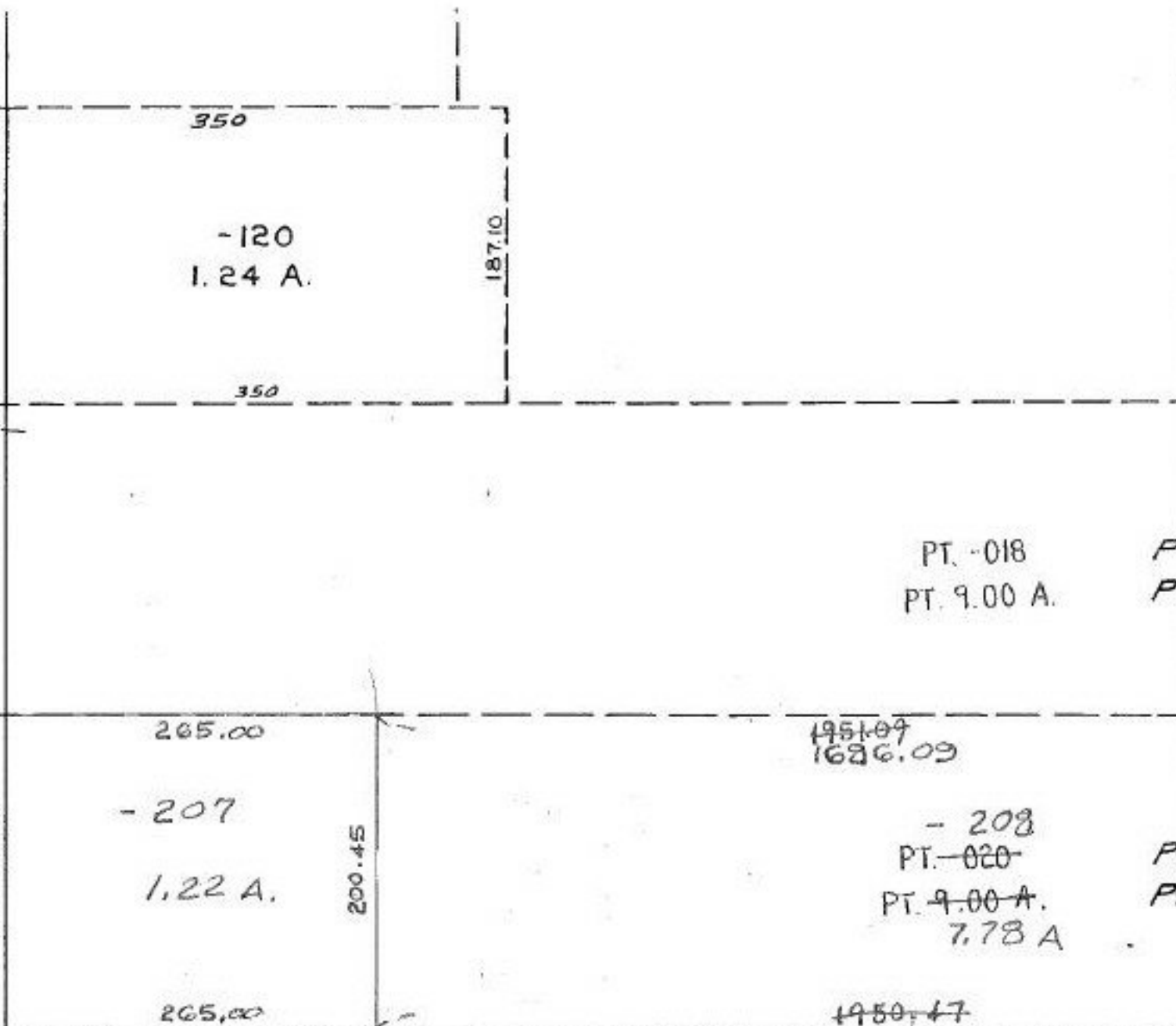

PT. -018 P  
PT. 9.00 A. P

- 208  
PT. -020 P  
PT. 9.00 A. P  
7.78 A

P.P. NO. 04-00-025-000-  
PRIOR INST: O.R. 778/491  
CLOSURE: 1.22 ac. C-1:333 452  
SURVEYED BY: LAUNDON, SIMON  
CAHL & ASSOC.

9-9-94

20840

APPROVED  
LORAIN CO.  
MAP DEPT.  
DATE 5-10-94  
PAGE 4-00-025A  
BY CAROLYN  
FRANCIS  
VOL # 20840