

300-39
031
24A.

110

1.17A
N 82° 46' W
569.50

300-39
310

P.P. NO. -015 SUBLOT (1)

- 017 — (3)
- 018 — (4)
- 020 — (6)
- 021 — (7)
- 022 — (8)
- +023 — (9)
- 024 — (10)
- 025 — (11)
- 026 + 205 (12)
- 014 B.21A N

-029
J. 007A

754.11
50° 12' W
890.12

No Ac. on Deed 1 & 2
DESCRIPTION

DEED CHECK

1/26/94

20507A X8-022

APPROVED
LORAIN CO.
MAP DEPT.
DATE 10-20-93
PAGE 5-00-037-B
BY CAROLYN
FRANCIS
VOID AFTER # 20507A

X9-023
X10-024

NORTH GATE
V. 17

581.78
S 72° 27' E

500

324.83
35
014
3.21A
H. RES.
ORD. 0-84-100
84-675
12-10-00
17-26-00

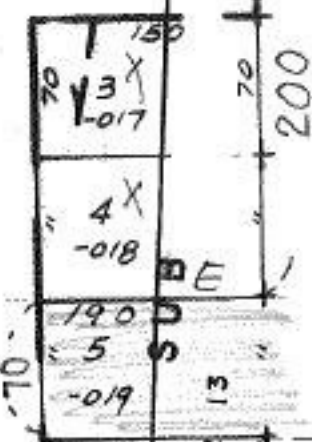
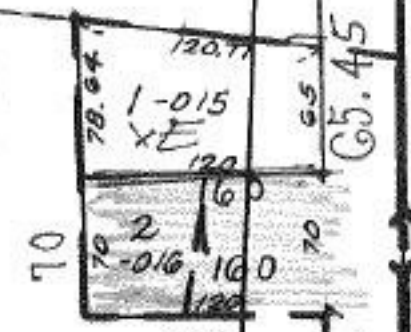

SEE SK
58
DEED

593.97
NO° 45