

N. PL. 2107.65
↑

125

-014
1.25 A.

435.60

50
16

125

~~039~~
PT. ~~038~~
PT. 45.66 A.
~~48.284~~
59.98 A

AC. CORR. KSA C=1: INF.

10-00-015-115- 10-00-015-116-
SURVEYED BY KS ASSOC. C=1: INF.

8/17/92
19597

APPROVED
LORAIN CO.
MAB DEBT.
DATE 10-8-91
PAGE 1000015-11
BY CAROLYN
FRANCIS
19597

1660.00 ←

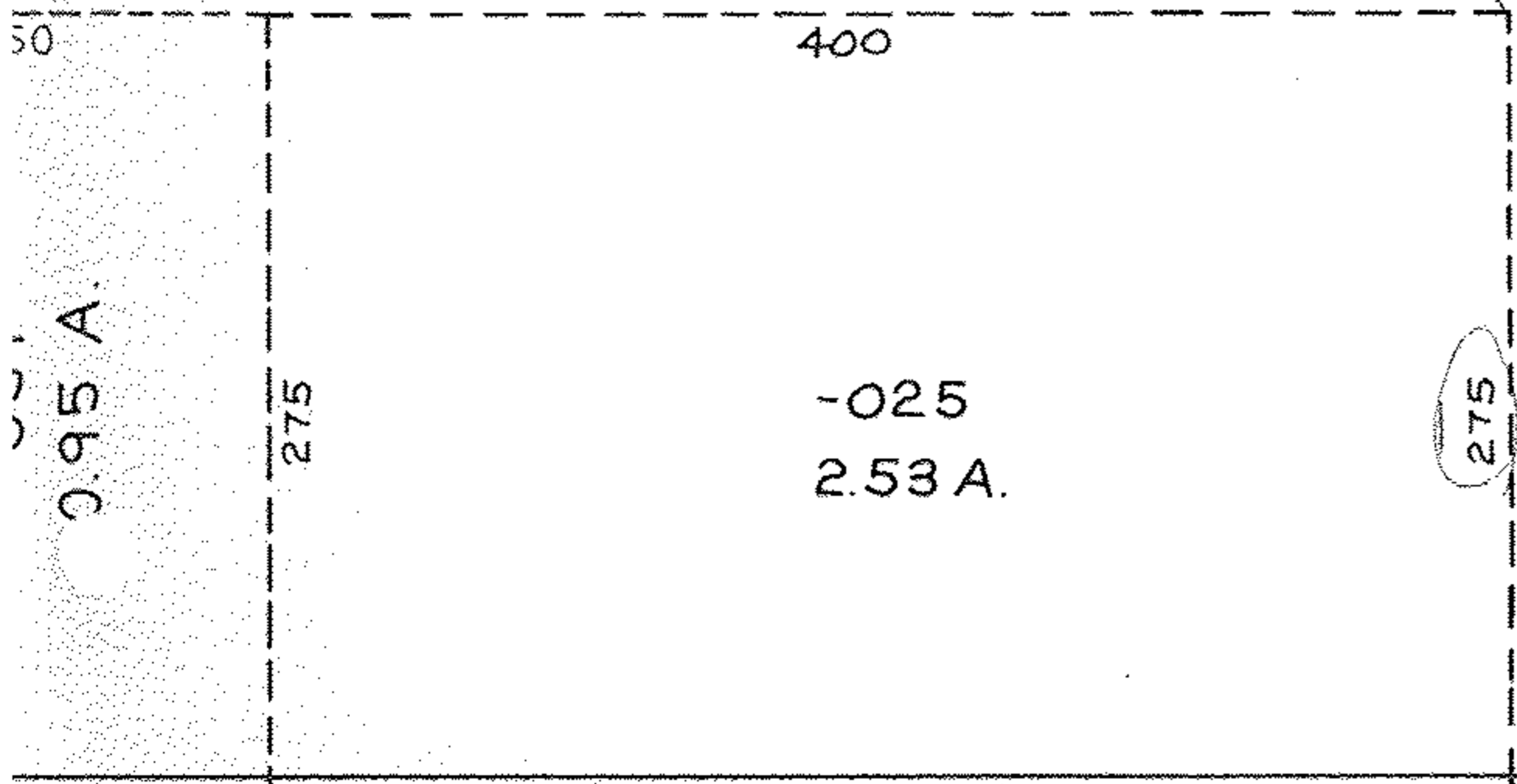

275

I.P. FOUND SET

590

972.20

MEDINA - ELYRIA RD.

SON

990 TO E S.R. 57 →

ROBSON

461.05

RD.

0
6

YRIA