

672.51
- 31.47
641.04

(C)
154,097

This is to certify that this plat was approved by the
Sheffield Lake by _____ No _____ passed
for record purpose only

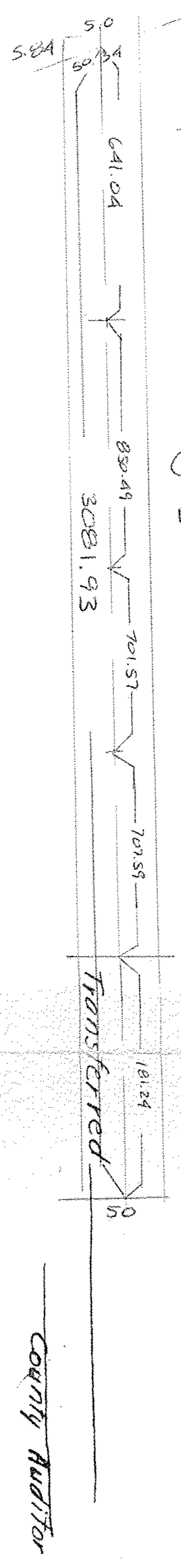

County Auditor

in and for said County, personally
Conger and Charles C. Bow who
a plat and that the same was their free
acres set my hand and affixed
of April 1913

W. A. Roth
Notary Public

Received for record AUGUST 17th 1923, at 10⁵⁰ o'clock
in Vol. 11 Page 11 Lorain County

#19327
APPROVED
LORAIN CO.
MAP DEPT.
DATE 4-10-91
PAGE 3-00-033-B
BY T. McMan
VOID
AFTER 19327

90.5
50 4525 ft.² (H) (J)

90
50 4500 ft.² (I) (K)

H, J, & I, K.
SAME SAME

COVE BEACH AVE (R/W ACREAGE)			
(A)	10,917	ft. ²	10,917
(B)	13,239		13,239
(C)	154,097		154,097
(D)	4,525		4,525
(E)	4,500		4,500
(F)	4,525		4,525
(G)	4,500		4,500
(H)	J 2@ 4,525		9,050
(I)	K 2@ 4,500		9,000
(TOTAL)		ft. ²	214,353
TOTAL ACREAGE			4.92 A

V. 11, P. 11
3-00-033-A
3-00-033-110, 111, 112

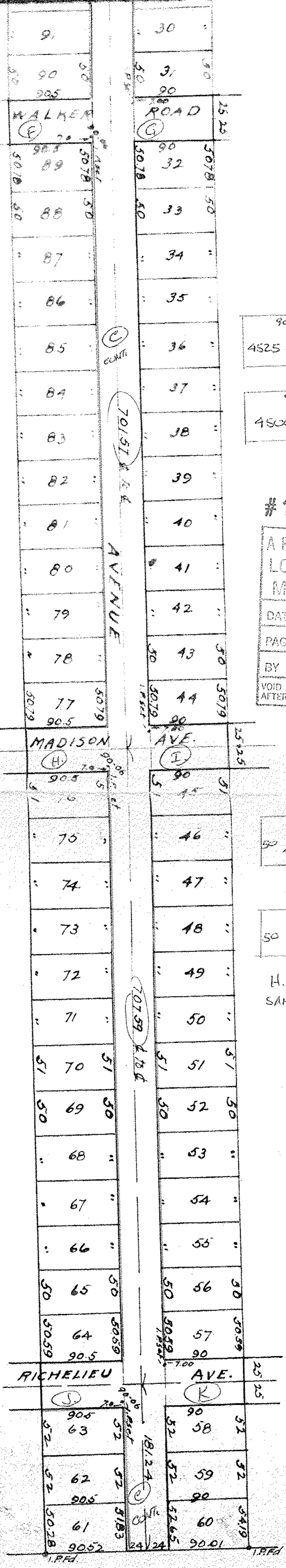

3-00-033-(3)-3

SURVEY MAP