

-006  
48.50 A.

7

-004  
50.00 A.

22/8.92

-001  
47.00 A.

LCPC

984.06

1034.68

471.94

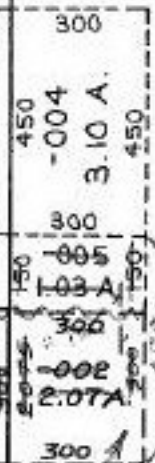

-006  
92.80 A.

12

-001  
47.00 A.

-007  
3.10 A.

703.06

2930

1/5/90  
COMBINATION  
#18776-A

APPROVED	
LORAIN CO.	
MAP DEPT.	
DATE 12/22/89	
PAGE 13-11	
BY T. HOLLIS	
VOID AFTER	18776-A

25

26