

BEEBE CT.

ST.

SULLY

HAWTHORNE ST. SEE 6-88

LONGFELLOW ST.

21

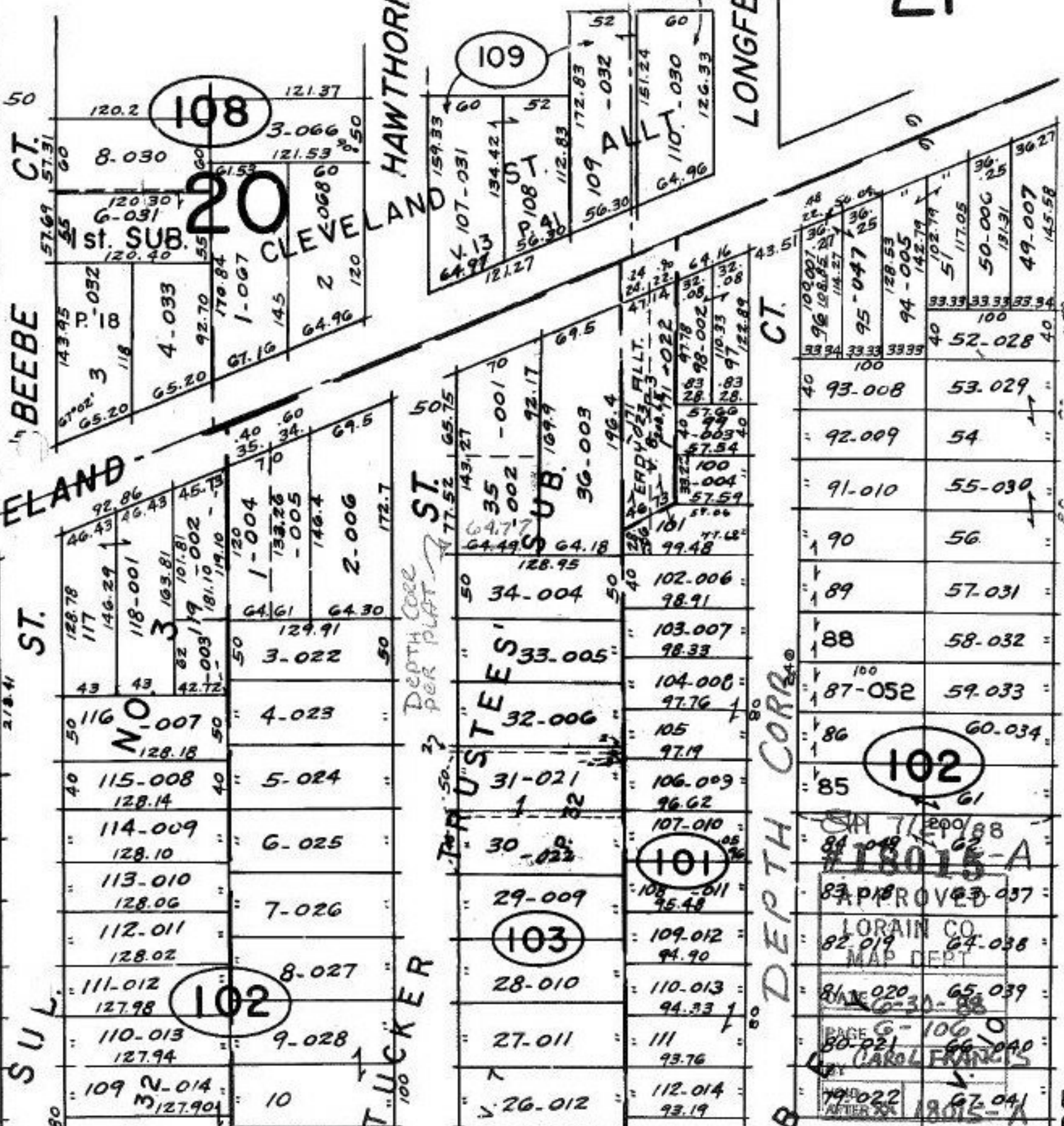

108

109

105

20

102

103

101

102

18015-A

APPROVED

LORAIN CO. MAP DEPT.

81-020 65-039

80-021 66-040

79-022 67-041

18015-A

DEPTH CORRS. ST.

DEPTH CORRS.

TUCKER

st. SUB.

ST.

CT.

50

143.95

118

118

117

117

117

117

117

117

117

117

117

117

117

117

117

57.69

57.31

57.69

57.31

57.69

57.31

57.69

57.31

57.69

57.31

57.69

57.31

57.69

57.31

57.69

57.31

57.69

57.31

57.69

57.31

57.69

57.31

57.69

57.31

57.69

57.31

120.2

8.030

120.30

120.40

120.30

120.40

120.30

120.40

120.30

120.40

120.30

120.40

120.30

120.40

120.30

120.40

120.30

120.40

120.30

120.40

120.30

120.40

120.30

120.40

120.30

120.40

121.37

3.066

121.53

121.53

121.53

121.53

121.53

121.53

121.53

121.53

121.53

121.53

121.53

121.53

121.53

121.53

121.53

121.53

121.53

121.53

121.53

121.53

121.53

121.53

121.53

121.53

121.37

3.066

121.53

121.53

121.53

121.53

121.53

121.53

121.53

121.53

121.53

121.53

121.53

121.53

121.53

121.53

121.53

121.53

121.53

121.53

121.53

121.53

121.53

121.53

121.53

121.53

121.37

3.066

121.53

121.53

121.53

121.53

121.53

121.53

121.53

121.53

121.53

121.53

121.53

121.53

121.53

121.53

121.53

121.53

121.53

121.53

121.53

121.53

121.53

121.53

121.53

121.53

121.37

3.066

121.53

121.53

121.53

121.53

121.53

121.53

121.53

121.53

121.53

121.53

121.53

121.53

121.53

121.53

121.53

121.53

121.53

121.53

121.53

121.53

121.53

121.53

121.53

121.53

121.37

3.066

121.53

121.53

121.53

121.53

121.53

121.53

121.53

121.53

121.53

121.53

121.53

121.53

121.53

121.53

121.53

121.53

121.53

121.53

121.53

121.53

121.53

121.53

121.53

121.53

121.37

3.066

121.53

121.53

121.53

121.53

121.53

121.53

121.53

121.53

121.53

121.53

121.53

121.53

121.53

121.53

121.53

121.53

121.53

121.53

121.53

121.53

121.53

121.53

121.53

121.53

121.37

3.066

121.53

121.53

121.53

121.53

121.53

121.53

121.53

121.53

121.53

121.53

121.53

121.53

121.53

121.53

121.53

121.53

121.53

121.53

121.53

121.53

121.53

121.53