

T. -036
P. 52.71 A.

1623.60

1044.71

SN 12/29/87
#17740

APPROVED
LORAIN CO.
MAP DEPT.

DATE 10-29-87

PAGE 12-00-044-B

BY *Joseph Francis*

VOID
AFTER 17740

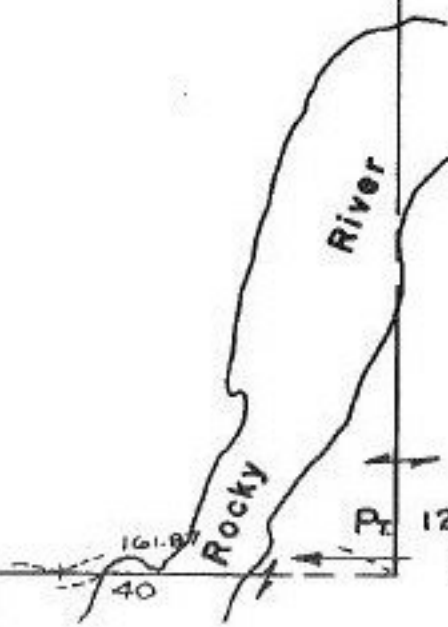

12-00-044-B

- 044-13

Pt. 12-00-036-000-023
Pt. 15.34 A. -036

44.10 Ac.