

1743

APPROVED  
LORAIN CO.  
MAP DEPT.  
DATE 5-8-68  
7-00-012-A.  
BY  
Kolbert.

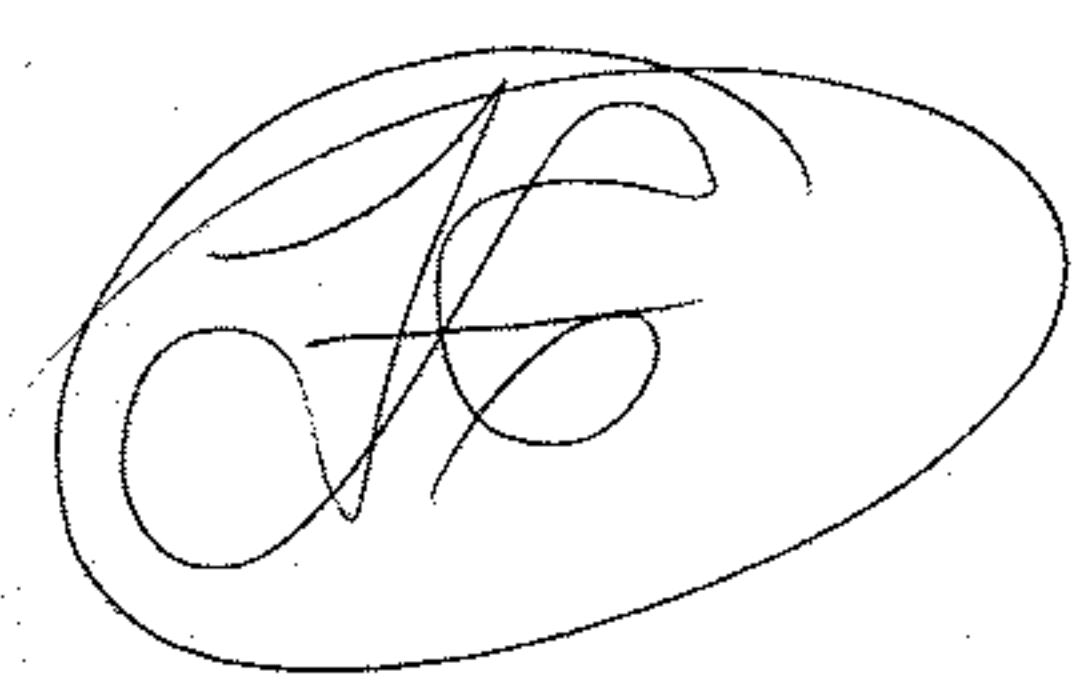
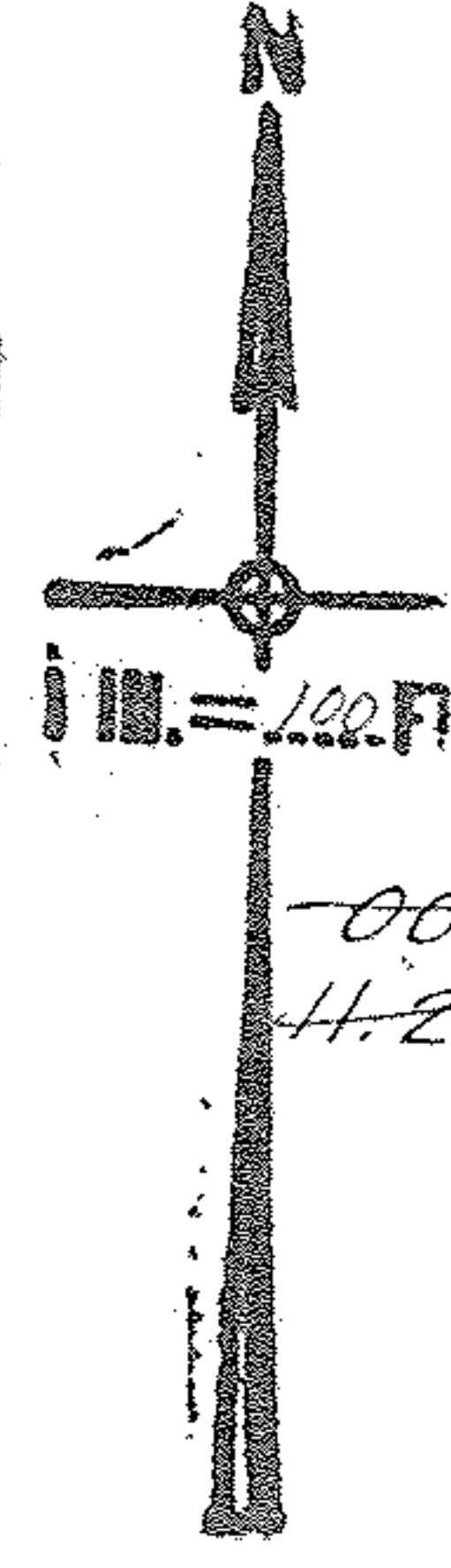

102

Pt. - 012  
Pt. 68.92 A.

-001  
0.75 A.

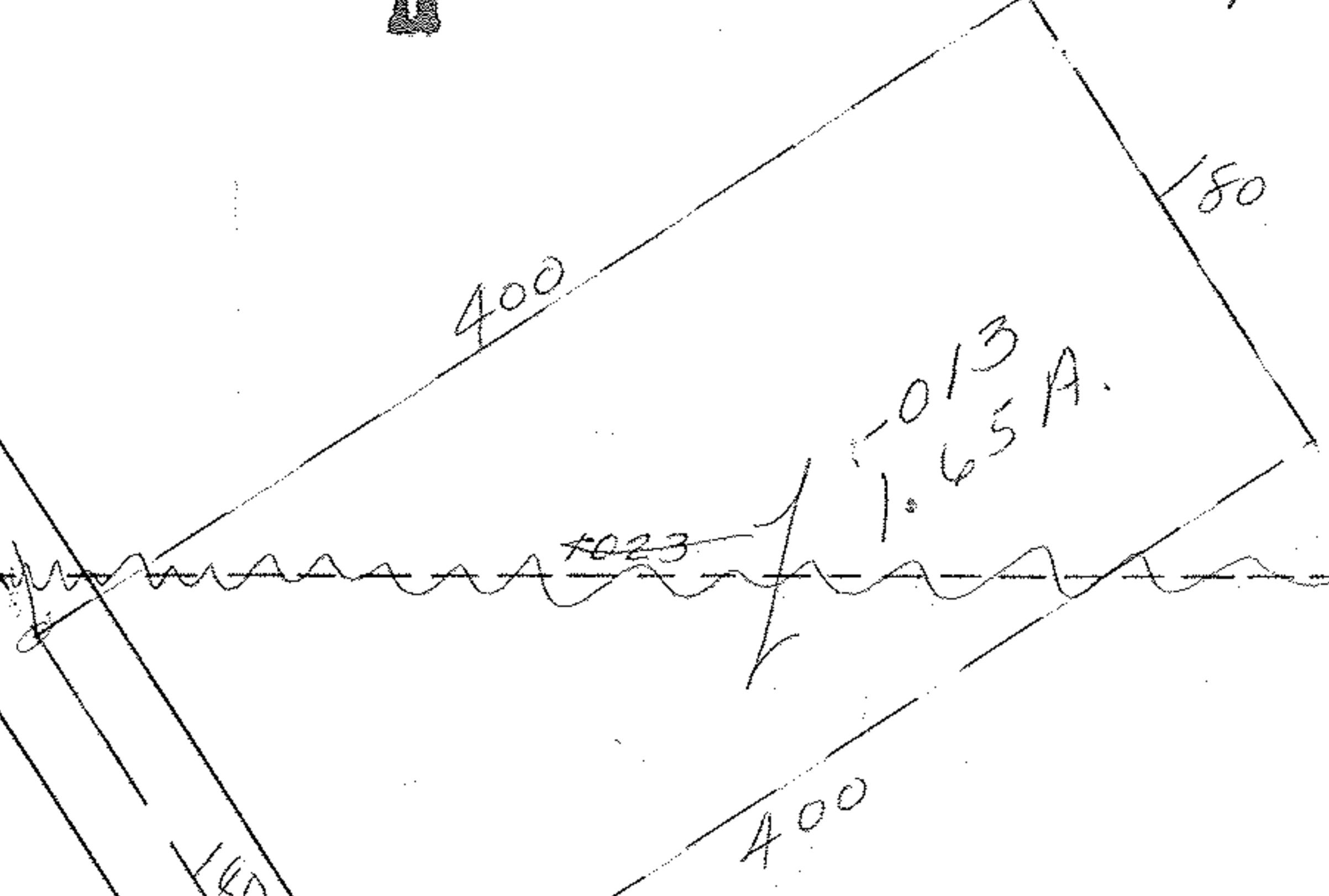

304.03

-002  
4.34 A.

-007  
5.66 A.

103

-003  
1.00 A.

-004  
1.00 A.

-008  
1.81 A.

672.38

286.90  
288.2  
243.20

RD.

519.47

427.08

139

530.58

519.42

SEE 7-H