

WOODFORD AVE.

90°

ST.

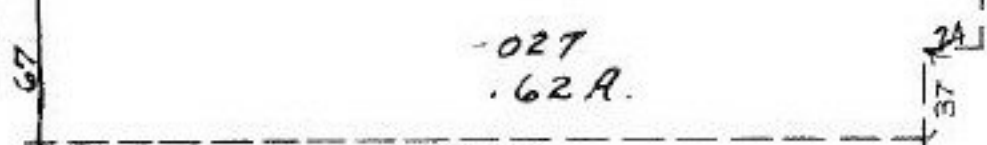
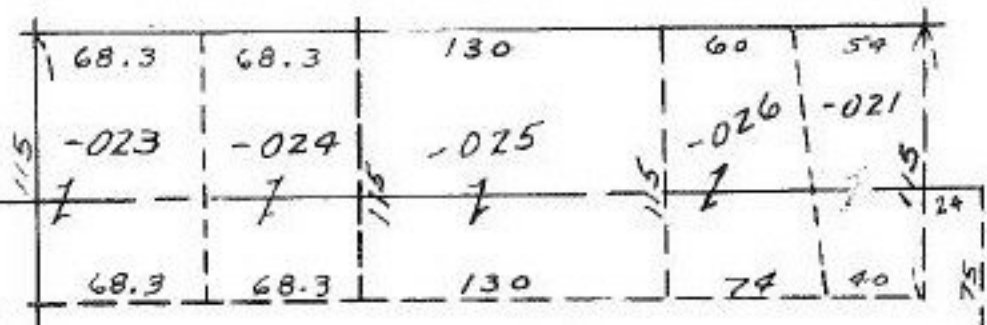

06-24-010  
06-24-009-102-

102

Pt. -029  
Pt. 13.27 A.

MAP CORRECTION

Ac. CORR. PER  
Survey By K.S.A.

GARDEN

Pt. ~~031~~  
Pt. ~~030~~  
Pt. ~~2-34A~~  
Pt. ~~2-09A~~

SN 4-6-87  
#17171

APPROVED  
ORAIN CO.  
MAP DEPT.

DATE 2-19-86

PAGE 6-116

BY C. FRANKS

VOID

6-116