

MIDDLE

750

550



CORRECT

P-3

038
11.20 Ac.
~~10.69 Ac.~~
10.92 Ac.

~~035~~

~~16.76 A.~~

Ac. AFTER subtraction of Exception.

372

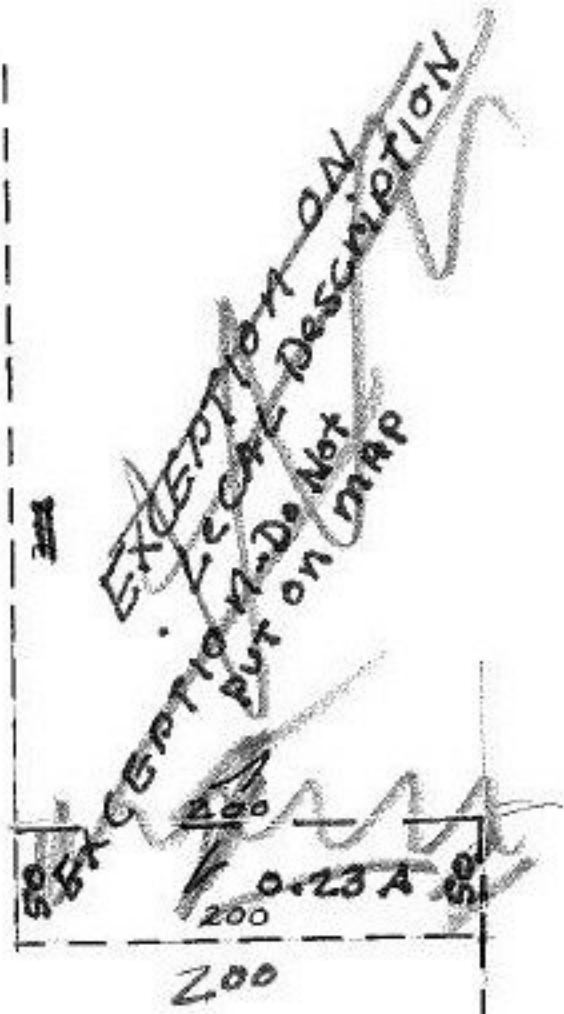

SA 11-12-86
#17036

378

APPROVED
LORAIN CO.
MAP DEPT.
DATE 9-29-86
PAGE 10-00-004
ORD 69-30
BY C. FRANCIS
VOID AND SEE 10-00-007-A

4-21-89

COMM.

ELYRIA CITY
CARLISLE TWP

750
CITY OF ELYRIA CORP.

750-3

CARL

W 1/2 SW 1/4 SEC. 4

SCALE 1" = 100'