

PARENT PARCEL: 01-00-054-000-014

CHILD PARCEL: 01-00-054-000-085 & -086

STARTING POINT: 1" I.P. MON. BOX, CL OF BAUMHARDT RD. & CL OF MIDDLE RIDGE RD.

17-00756

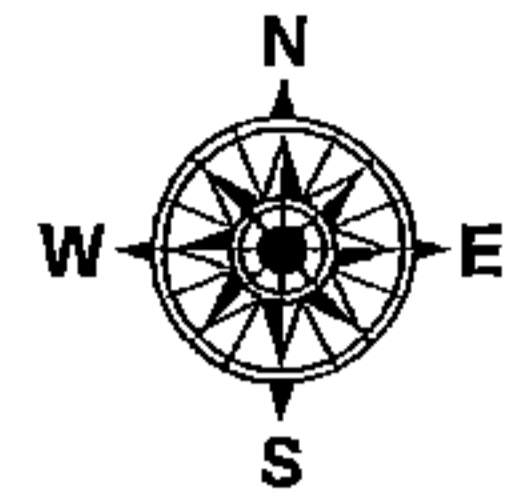

-028
2.24

368.77

112.40

-026
1.58

150

326.53

367

480.19

453.97

185.78

32.87

98.16

136.50

4.50

-086

0.44 A.

80

-014

82.83

80

.72

48 -082

10-WDV

-085

0.28 A.

181.13

214.50

132

RD.

294.59

394.43

5.00

32.89

80

394.58

18.46

99.97

49

6-WDV2

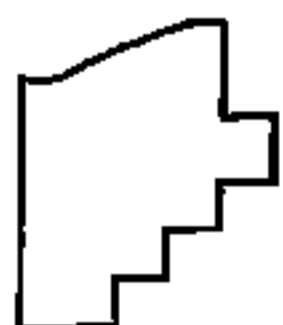

SPLITS/DEEDS PROCESSED

LORAIN COUNTY TAX MAP DEPARTMENT
226 MIDDLE AVE. ELYRIA, OH

SURVEYED BY: AMY KELLY

CLOSURE: 1: 33,000

MAP PAGE(S): 01-00-054

APPROVED BY: TJS DATE: 1/31/17

SCALE: 1" = 60' PRIOR INSTRUMENT: DV 1077/294