

T  
R  
A

-038  
165.00A.

-017  
19.41A

1418.61

-018  
40.00A

COMBINATION

1485.0

-041  
25.51A.  
28.07A

-03  
25.00

-031  
5.00A

-010  
4.43A.

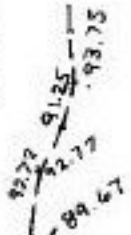

-009  
6.00A.

013  
50A.

014  
50A.

-00

-003  
10.00A.

8

-002  
27.70A.

-004  
21.50A.

21-15-000-000-

-007  
7.37A.

-005  
7.37A.

-001  
31.50A.

9

1092

-008

HAWLEY

8/12/86  
#16799

APPROVED  
LORAIN CO.  
MAP DEPT.

DATE 6-19-86

PAGE 21-G

BY C. FRANCIS

VOID AFTER 16799

575.01

565.72

2259.84

2259.84

567.1

458.1

366.6

189.61

694.71

311.73

230.06

624.30

615

1089.0

1524.10

708.29

208.29

615

2269.14

294.01

294.01

01

1470.1