

~~Pt. 022~~      ~~Pt. 024~~  
~~Pt. 55.22A~~      ~~Pt. 54.27A~~

Pt. -026  
Pt. 51.74 A.

#15801

APPROVED  
LORAIN CO.  
MAP DEPT.

DATE 9.14.84

PAGE 10.00.015.6

BY T. McManis  
VOID

9/23/84  
*[Signature]*

09/12/85

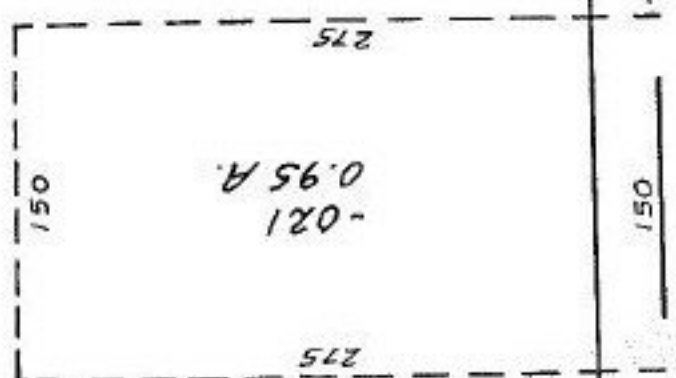

2100

RD.