

~~Pt. 024~~
~~Pt. 54.27 A~~
~~Pt. 022~~
~~Pt. 55.22 A~~

Pt. 026
Pt. 51.74 A.

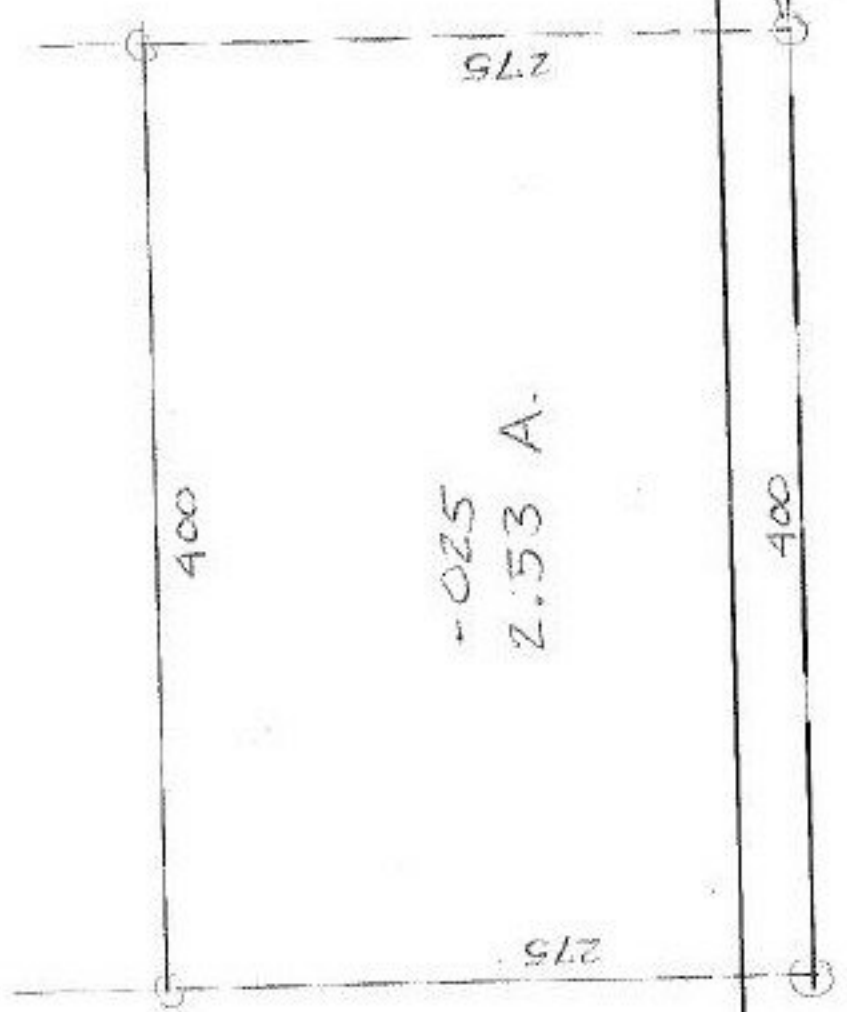

1950
926
960

9/20/85

08/17/85

#15801

APPROVED.
LORAIN CO.
MAP DEPT.

DATE 9-14-84

PAGE 10-00-015 H

BY T. McMain

VOID
IF
REPLACED

ELYRIA

RD.

461.05

590

400

SOA