

OL 39

- 007
4.78A.

636
603.8
396.31
654.18

- 008
4.26A.

844.89
N51°22'W

S87°22'E
498.20
418.20

- 009
4.69A.

PT. 12.00.043-000-018

PT. 7.39A
PT. 6.08A

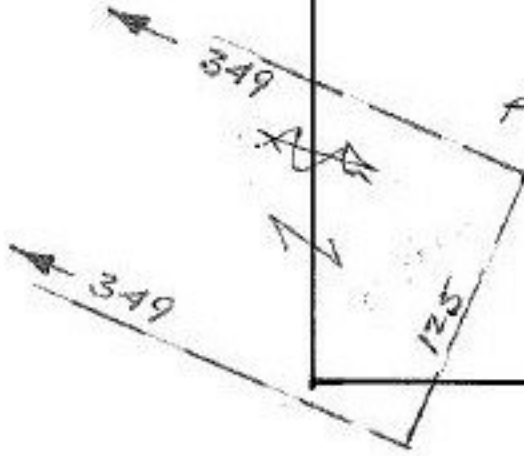

#15636 SEE 1

APPROVED
LORAIN CO.
MAP DEPT.

COLUMBIA T

DATE 6.7.84

PAGE 12.00.039-A

BY T. McMain

VOID
T.H. 8/6/84

39-A

SCALE: 1" = 100'