

LORAIN COUNTY MAP DEPT.  
P. P. No. \_\_\_\_\_

LORAIN COUNTY MAP DEPT.  
P. P. No. \_\_\_\_\_

WOODFORD AVE.

ST.

GARDEN

90°

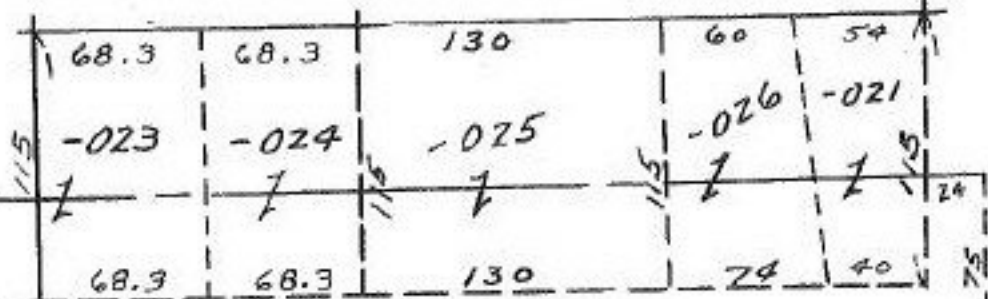

102

-029  
Pt. 028  
Pt. 15.61A.  
13.27 Ac

#15466

APPROVED  
LORAIN CO.  
MAP DEPT.

DATE 3-8-84

TYPE 6-116

BY *L. Colwell*

NO. 15466

9-11-85

NO-16E  
539.22

516.50 D.

875.89

40

319.39

417

304.28

380.85

15.61  
13.27  
2.34  
1067.06

300  
-010-101-005  
300  
28A.  
1067.06

N 79-59E 134.32  
S 10-01E 167.44  
N 79-59E 809.27

134.32  
167.44  
Pt. 030  
Pt. 2.34 Ac.

804.27