

SEE

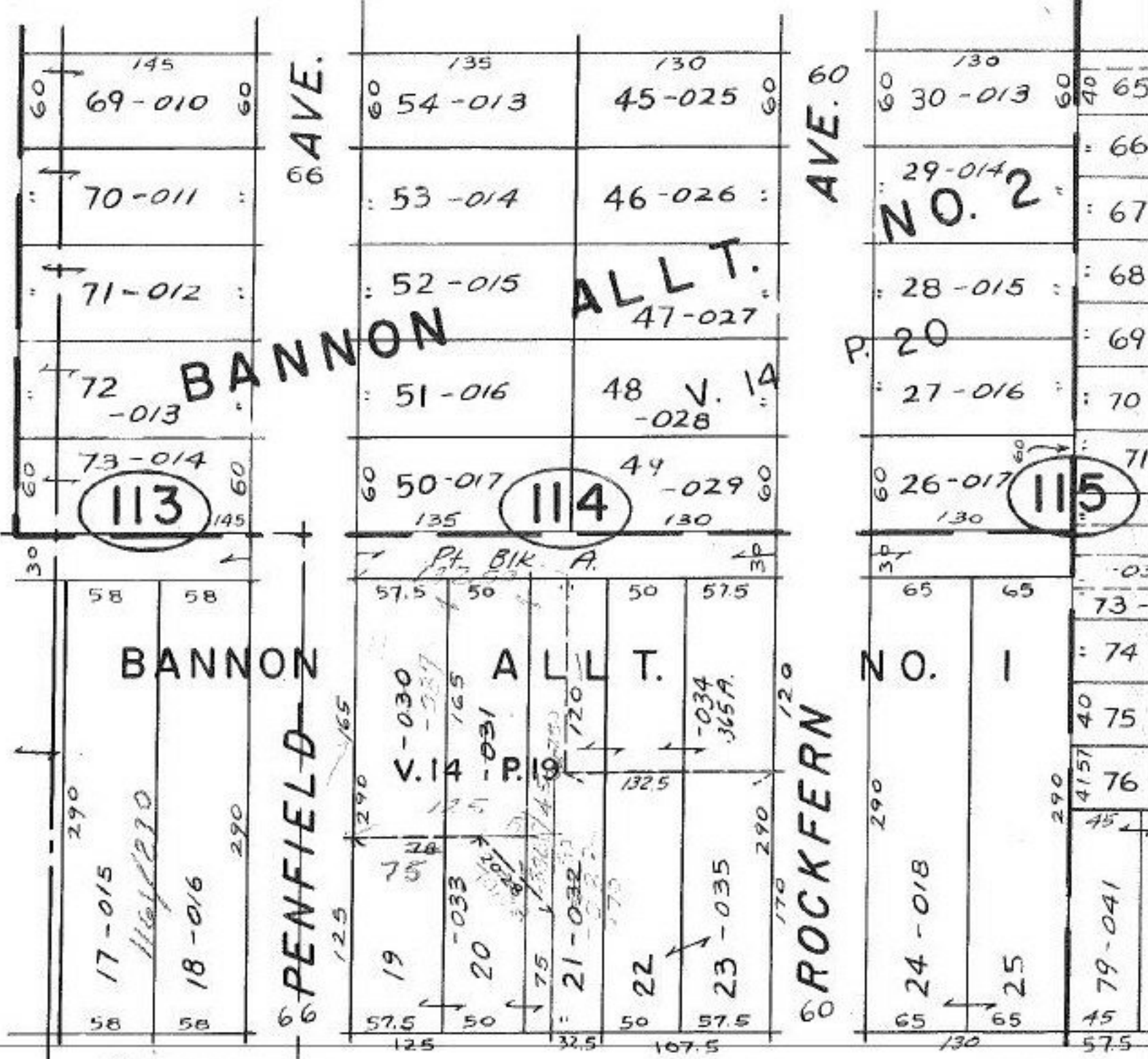

LOWELL.
 SURVEYED BY: McGLINCHY & Assoc.
 3/82
 CLOSURE 1:9.999,999.99

#14744

APPROVED
 LORAIN CO.
 MAP DEPT.
 DATE 6-30-82
 PAGE 1-97
 BY P. F. FRANKS
 VOID AFTER

JAN 21 1983

101