

235.84

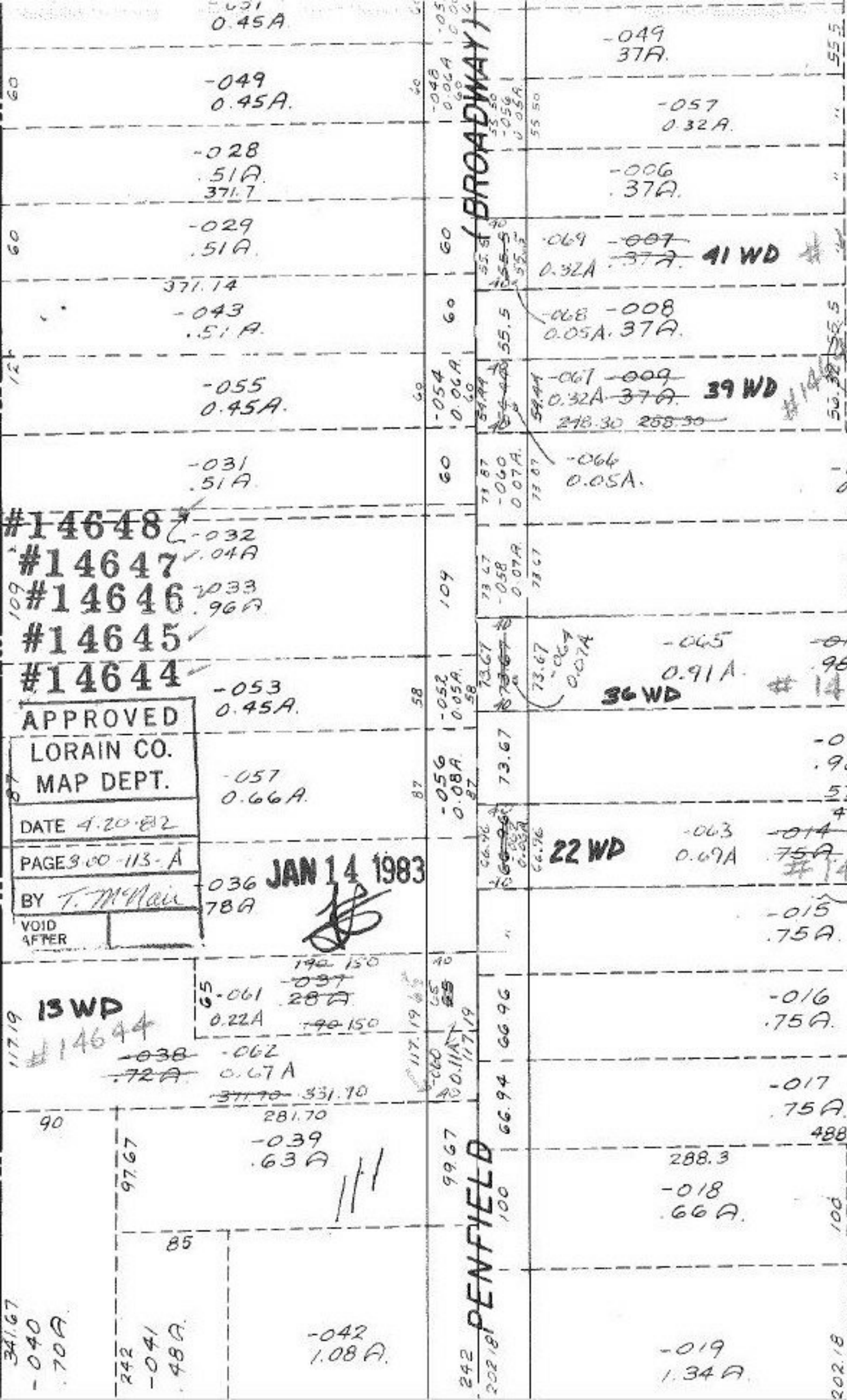

BLK 102

4648

BLK 104

#14648 ✓
 #14647 ✓
 #14646 ✓
 #14645 ✓
 #14644 ✓

APPROVED
 LORAIN CO.
 MAP DEPT.
 DATE 4.20.82
 PAGES 00-113-A
 BY T. McNeil
 VOID AFTER

JAN 14 1983

BR 36 329 444
05 00 113-102-05E

13WP

22WP

36WP

39WP

41WP

341.67
-040
.70A

242
-041
.48A

-042
1.08A

242
202/8
PENFIELD

-019
1.34A

202/8
202/8

-020
.76A

117.19
#14644

-038
.72A

-062
0.67A

311.70 331.70

-039
.63A

192 150
-037
.28A
192 150

65
-061
0.22A

-016
.75A

-017
.75A

488

288.3
-018
.66A

-013
.98A

576.6
488 448

-063
0.67A

-014
.75A
#14645

-015
.75A

-012
.98A

#14646

-065
0.91A

-067
0.07A

-059
0.91A

-061
0.88A

536.60

-066
0.05A

-067 -009
0.32A 37A
248.30 258.30

39WP

-068 -008
0.05A 37A

-069 -007
0.32A 37A

41WP

-006
37A

-057
0.32A

-049
37A

0.45A

-049
0.45A

-028
.51A
371.7

-029
.51A

371.14

-043
.51A

-055
0.45A

-031
.51A

-032
.04A

-033
96A

-053
0.45A

-057
0.66A

036
78A

65
-061
0.22A

-038
.72A

281.70

-039
.63A

97.67

85

99.67

66.94

66.94

66.94

66.94

66.94

66.94

117.19

65

65

65

65

65

65

65

60

60

60

60

60

60

60

60

60

60

60

60

60

60

60

60

60

60

60

60

55.5

55.5

55.5

55.5

55.5

55.5

55.5

55.5

55.5

55.5

55.5

55.5

55.5

55.5

55.5

55.5

55.5

55.5

55.5

55.5

110

100

100

100

BROADWAY

PENFIELD