

PARENT PARCEL: 07-00-017-124-028
CHILD PARCEL: 07-00-017-124-037, -038
STARTING POINT: INTERSECTION OF C/L OF CENTER RIDGE RD. AND C/L OF WALLACE BLVD.

14-00672

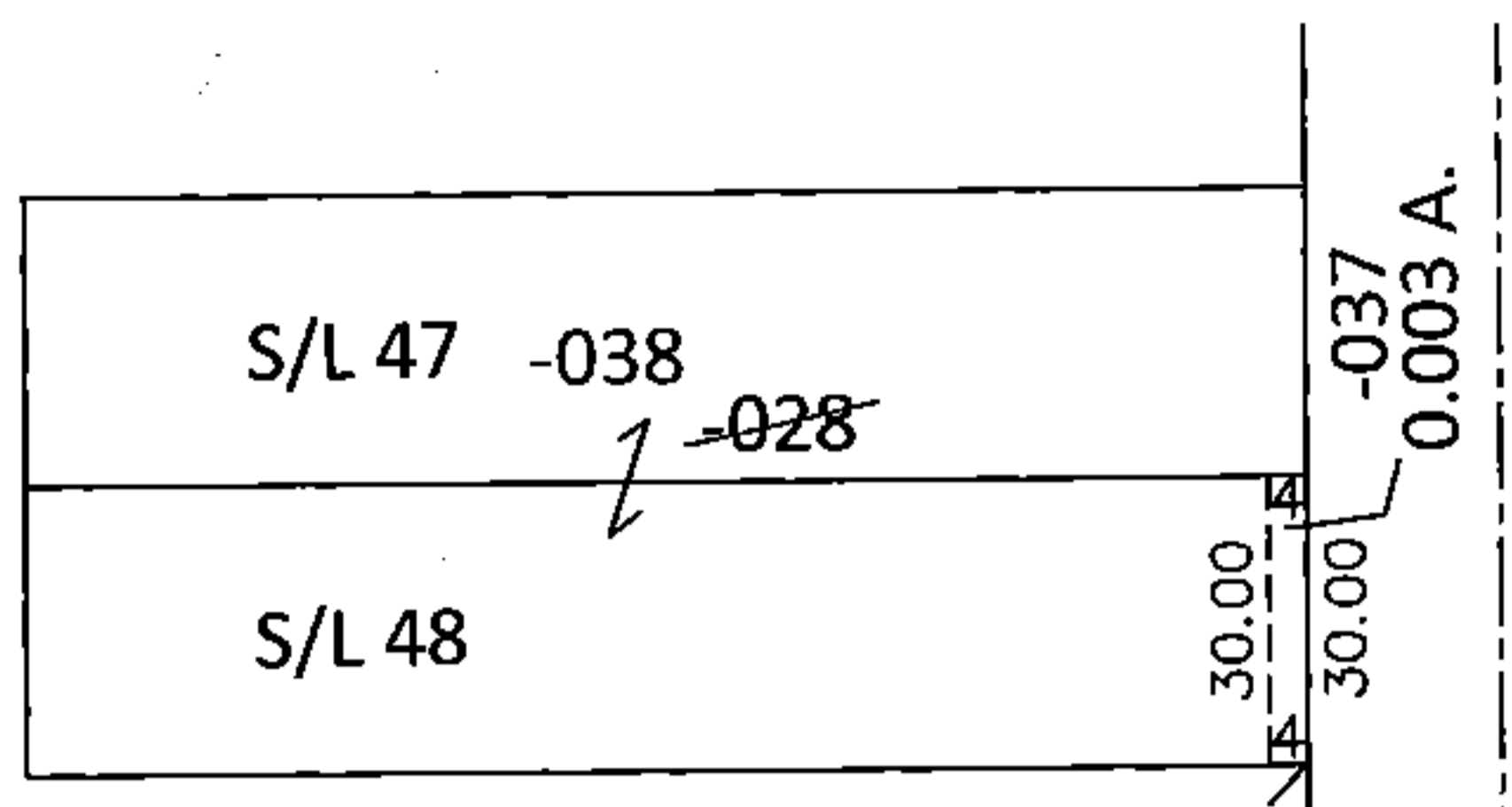
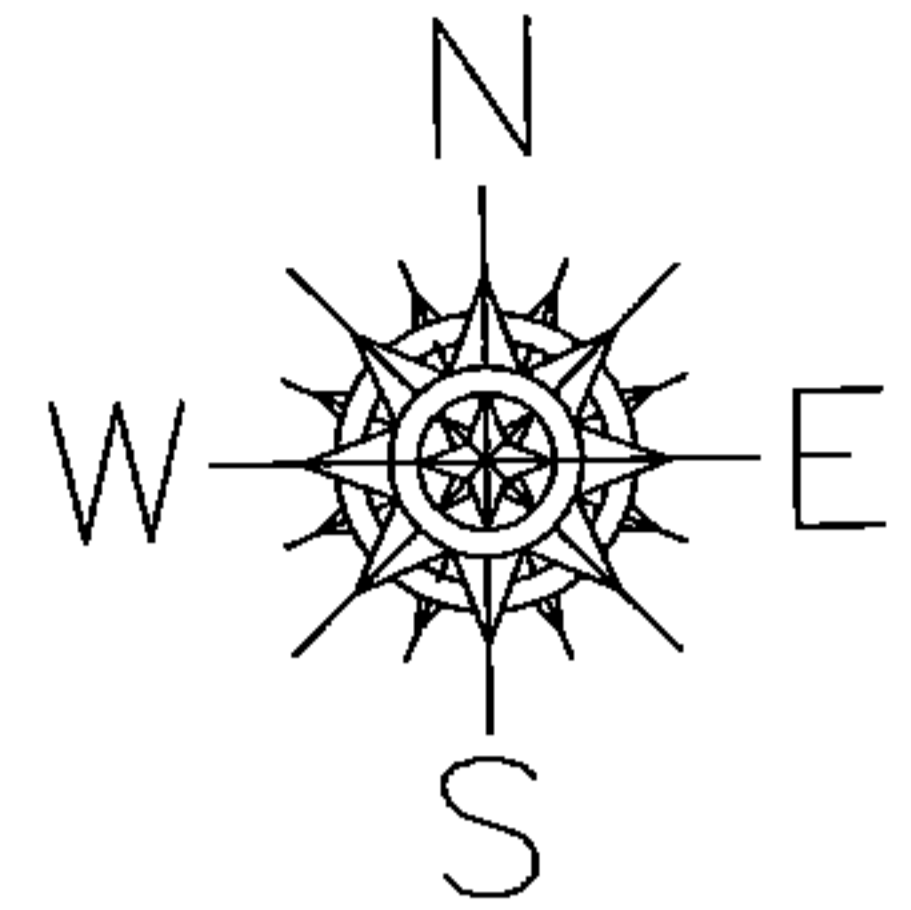

~~07-00-017-124-028~~
~~60 X 133~~
07-00-017-124-037 07-00-017-124-038
0.003 A. 60 X 129 IRR

LOR-20-22.13
302-WDV

275.82

WALLACE BLVD.

23.85
CENTER RIDGE RD.

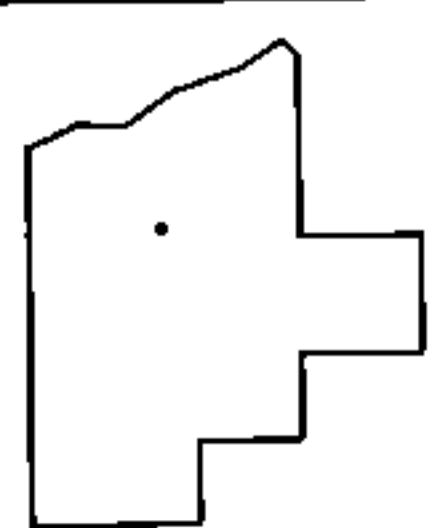

SPLITS/DEEDS PROCESSED
LORAIN COUNTY TAX MAP DEPARTMENT
226 MIDDLE AVE. ELYRIA, OHIO

SURVEYED BY: WILLIAM D. THOMAS
CLOSURE: .01:10,000
MAP PAGE(S): 7-00-017-D
APPROVED BY: RRM DATE: 3-30-15
SCALE: 1"=50' PRIOR INST.: 20120424721