

PARENT PARCEL: 16-00-070-000-006

CHILD PARCEL: 16-00-070-000-016, -017

STARTING POINT: NORTHWEST CORNER OF O.L.70

13-00437

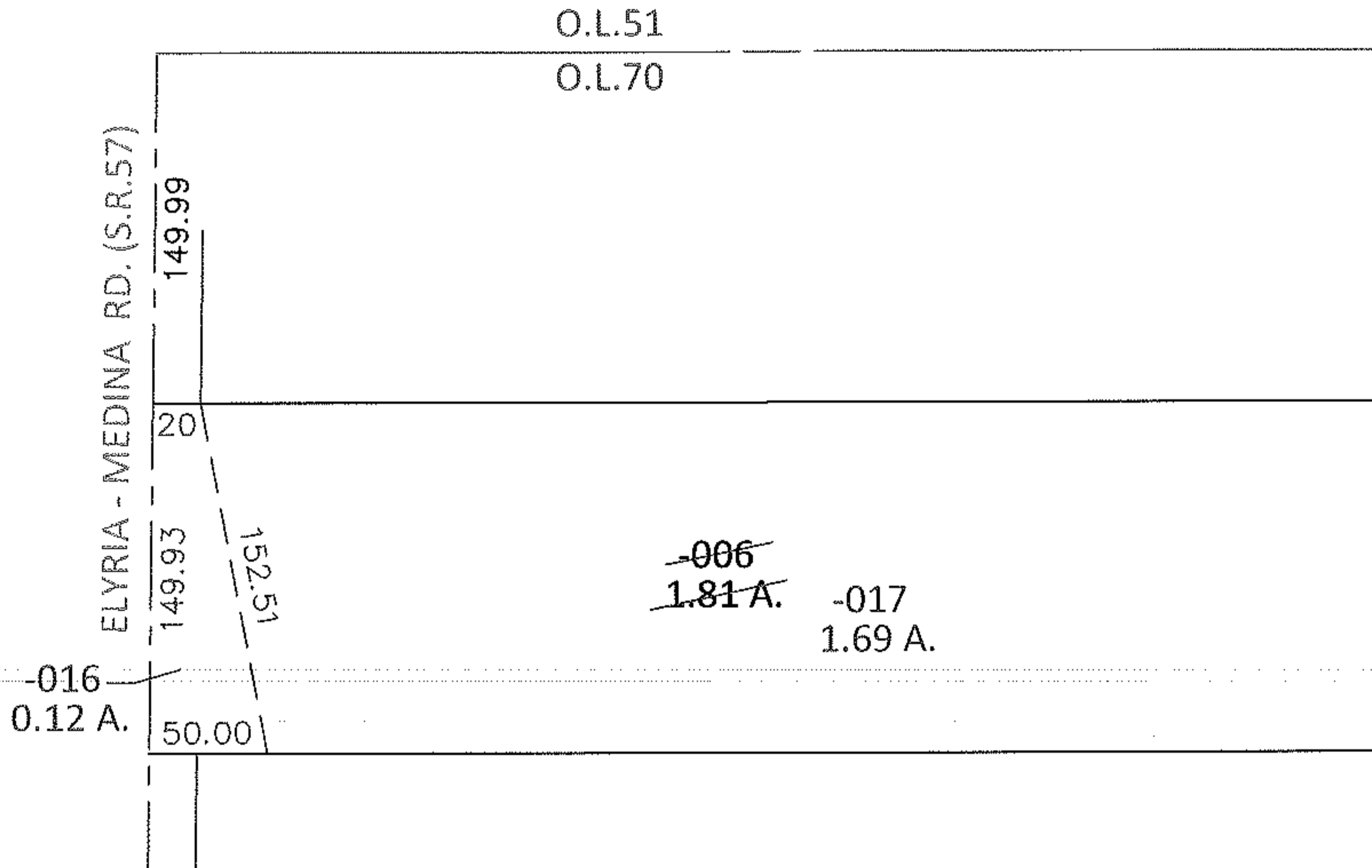
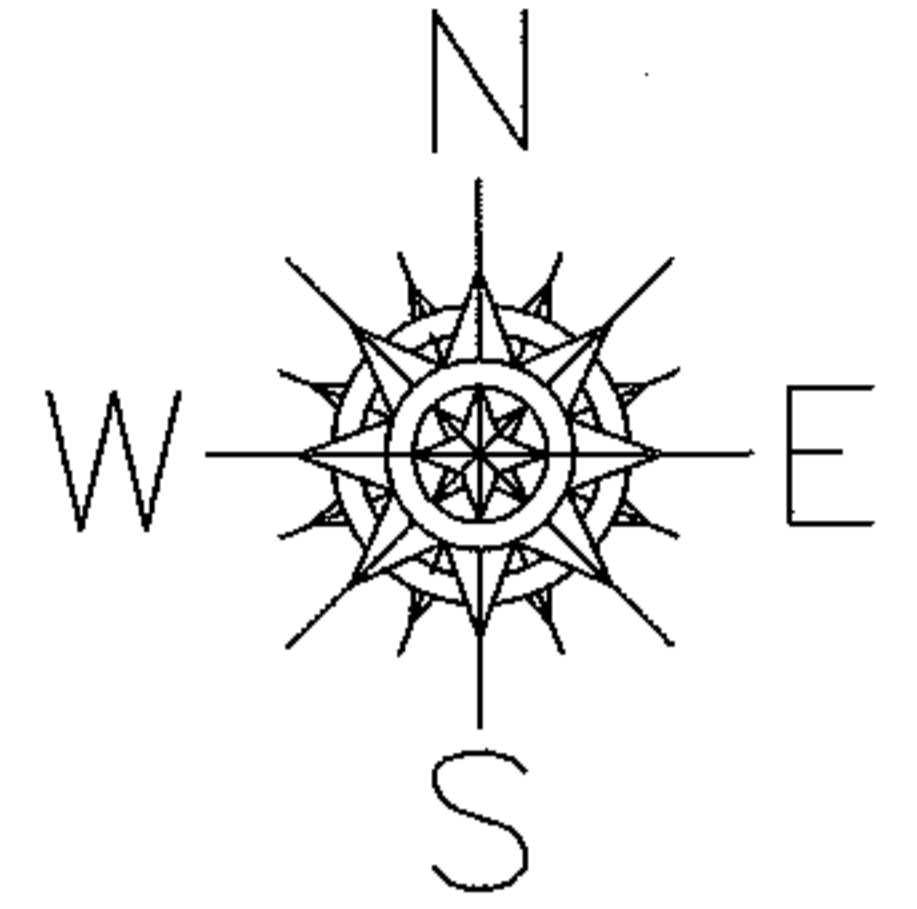

LOR-57-2.22

6-WD

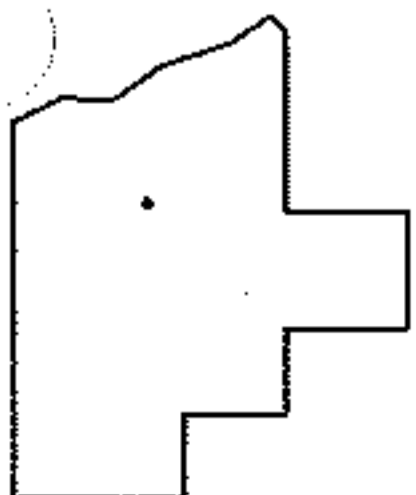

SPLITS/DEEDS PROCESSED

LORAIN COUNTY TAX MAP DEPARTMENT  
226 MIDDLE AVE. ELYRIA, OHIO

SURVEYED BY: KEVIN CANAVAN

CLOSURE: .01:10,000

MAP PAGE(S): 16-H

APPROVED BY: RRM DATE: 6-26-13

SCALE: 1" = 100 PRIOR INST.: OR 378/65