

PARENT PARCEL: 03-00-109-132-005

CHILD PARCEL: 03-00-109-132-022, -023

STARTING POINT: NORTHWEST CORNER OF S/L 3 IN ESCHTRUTH ALLOT.(VOL.7 PG.48)

13-00376

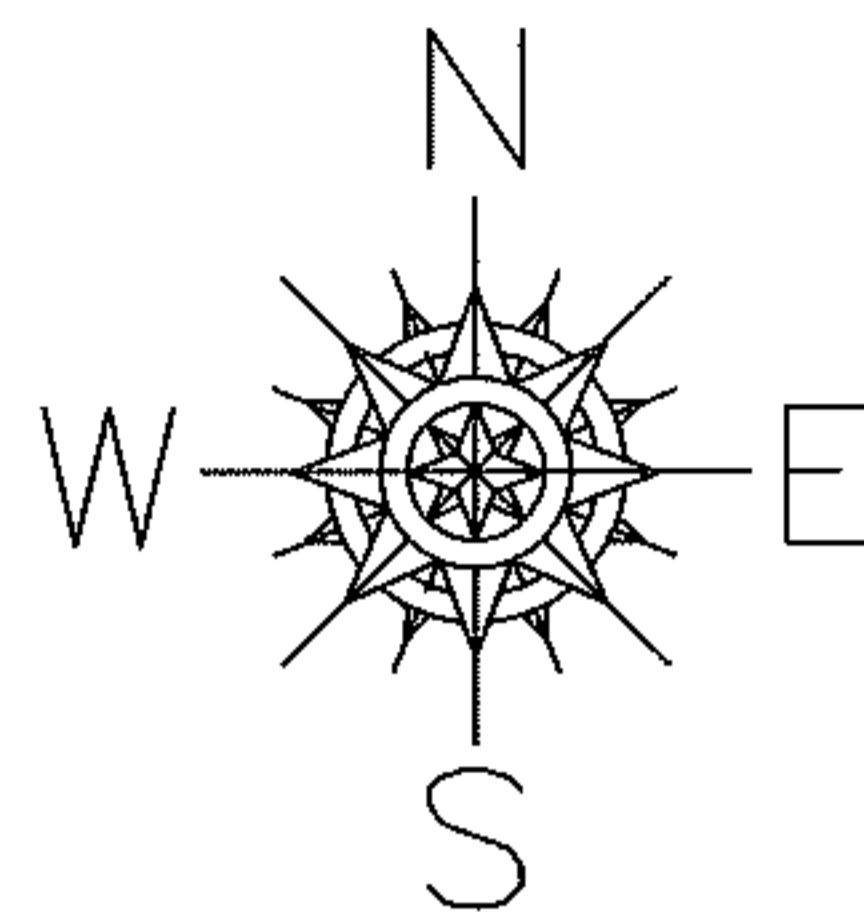

NORTH RIDGE RD. (S.R. 254)

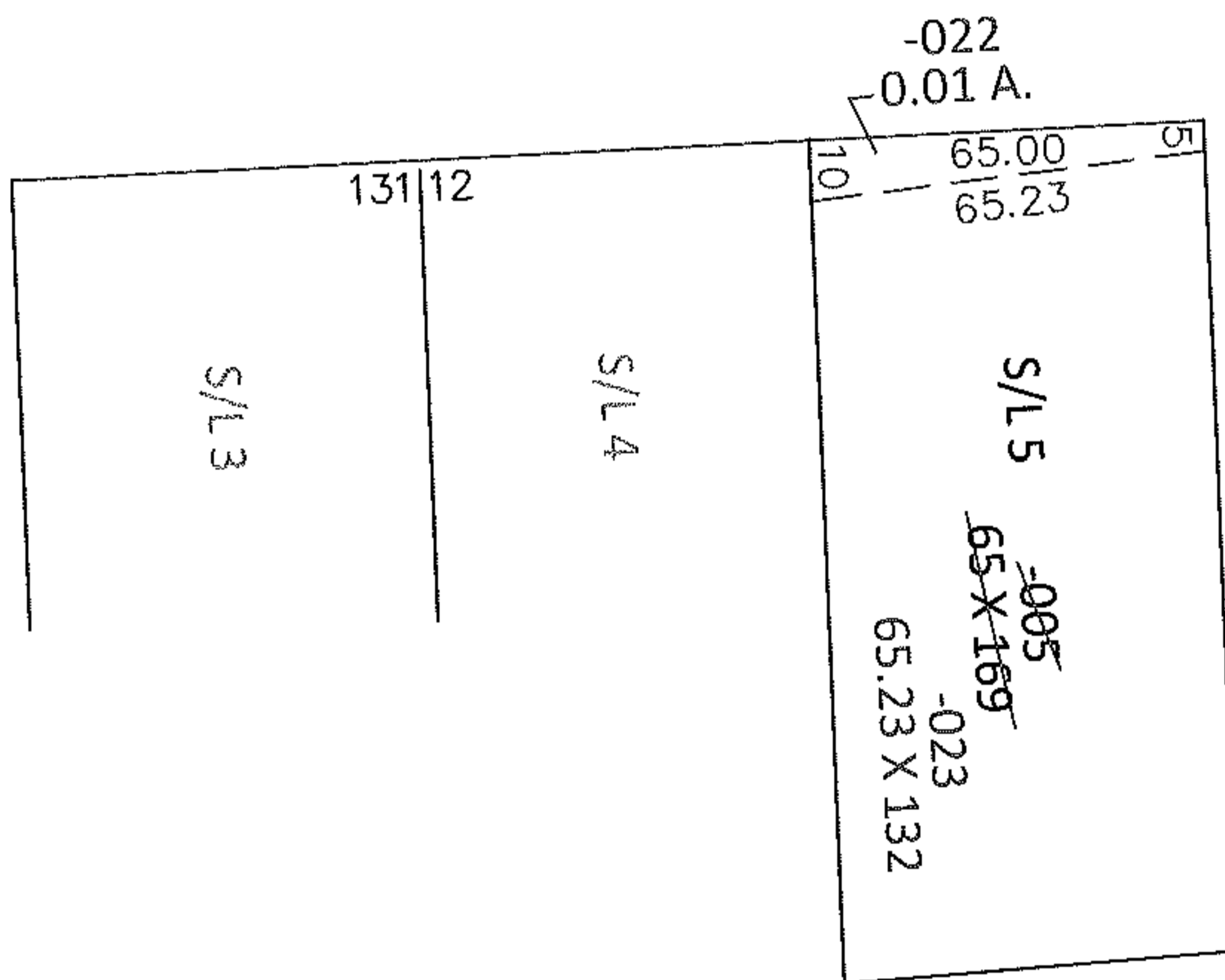

LOR-254-0.01

6-WD

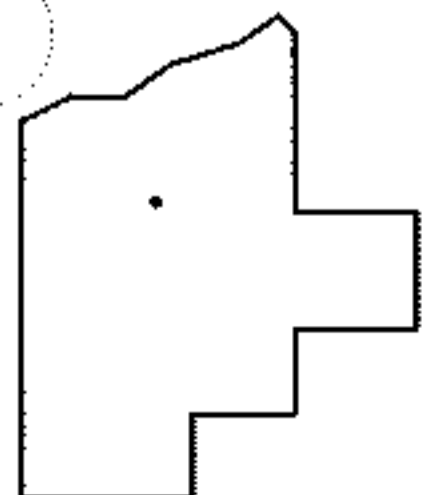

SPLITS/DEEDS PROCESSED

LORAIN COUNTY TAX MAP DEPARTMENT
226 MIDDLE AVE. ELYRIA, OHIO

SURVEYED BY: RICHARD F. MATHIAS

CLOSURE: .00:10,000

MAP PAGE(S): 3-00-109-B

APPROVED BY: RRM DATE: 2-19-13

SCALE: 1"= 50' PRIOR INST.: 20130446204