

PARENT PARCEL: 11-00-098-000-030, -031

CHILD PARCEL: 11-00-098-000-271 THRU -273

ARTING POINT: NORTHWEST CORNER OF S/L 12 IN C.A. MILLER SUB. (VOL.17 PG.13)

13-00367

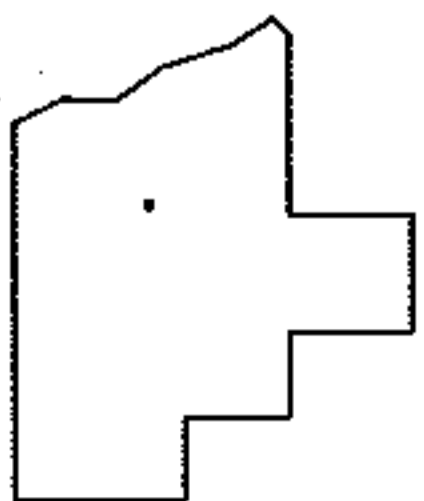
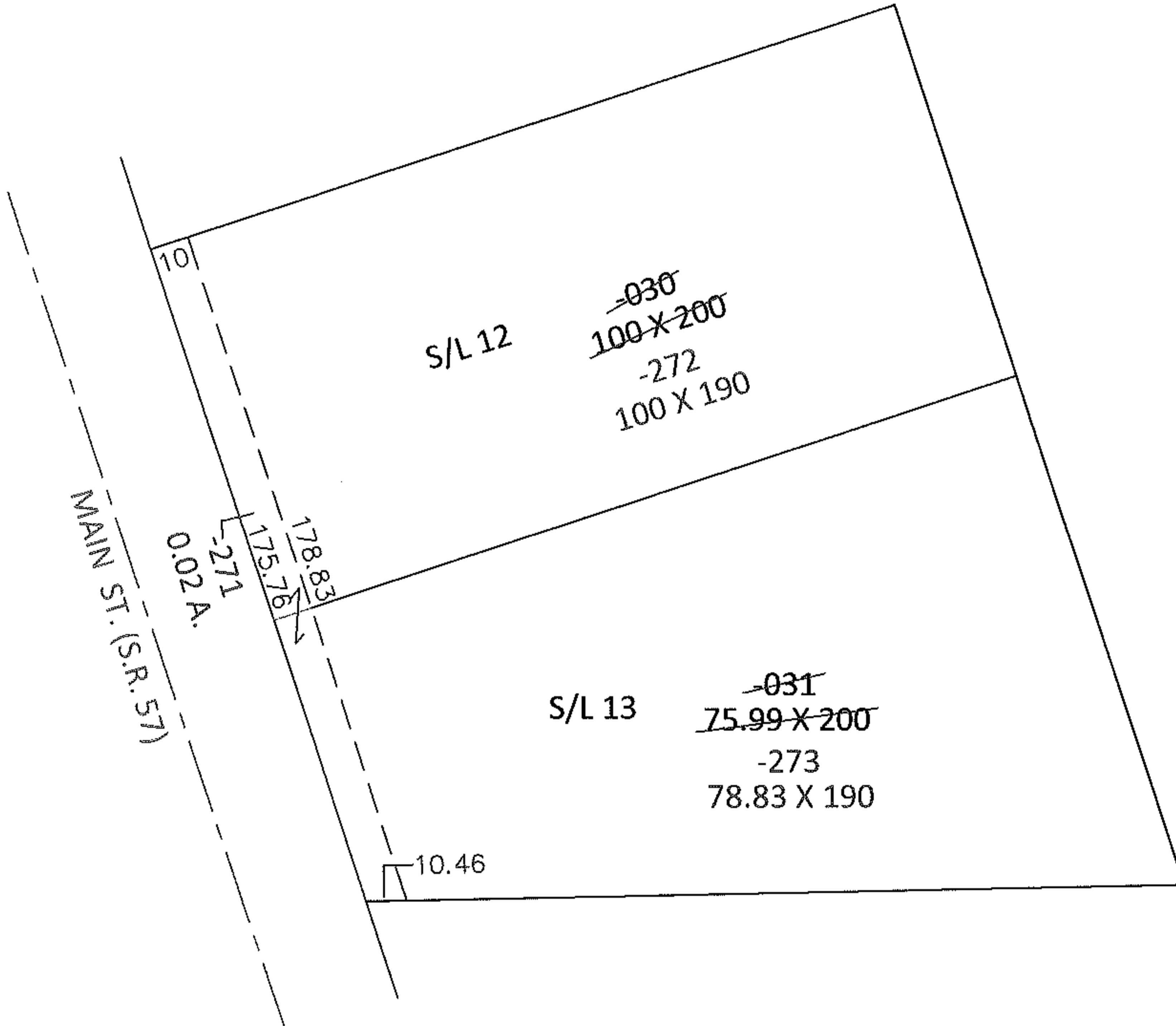
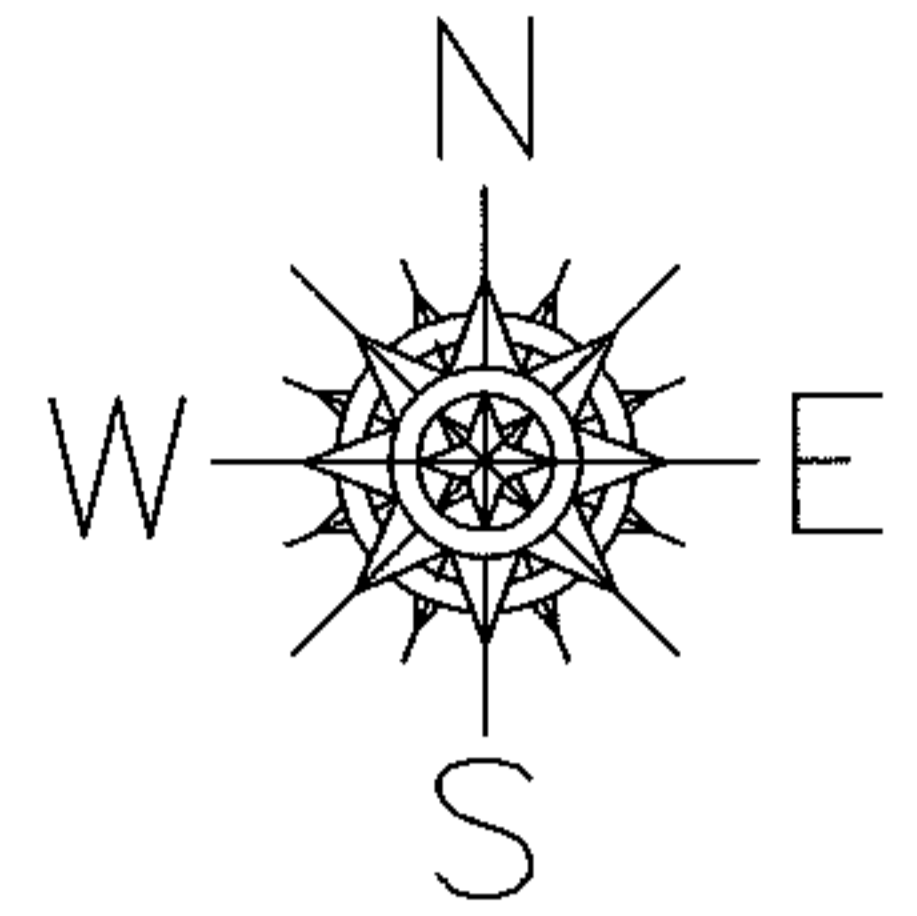

**SPLITS/DEEDS PROCESSED**

LORAIN COUNTY TAX MAP DEPARTMENT  
226 MIDDLE AVE. ELYRIA, OHIO

SURVEYED BY: KENNETH C. DEAN JR.

CLOSURE: .00:10,000

MAP PAGE(S): 11-00-098-A

APPROVED BY: RRM DATE: 1-3-13

SCALE: 1" = 50' PRIOR INST.: 20070192190