

Pt. -058
Pt. 66.47 A.

MAP
CORRECTION
ONLY

#12777

OCT 29 1979



APPROVED	
LORAIN CO.	
MAP DEPT.	
DATE 6-7-79	
PAGE 11-00-008B	
BY <i>J. Colman</i>	
VOID	
AFTER	

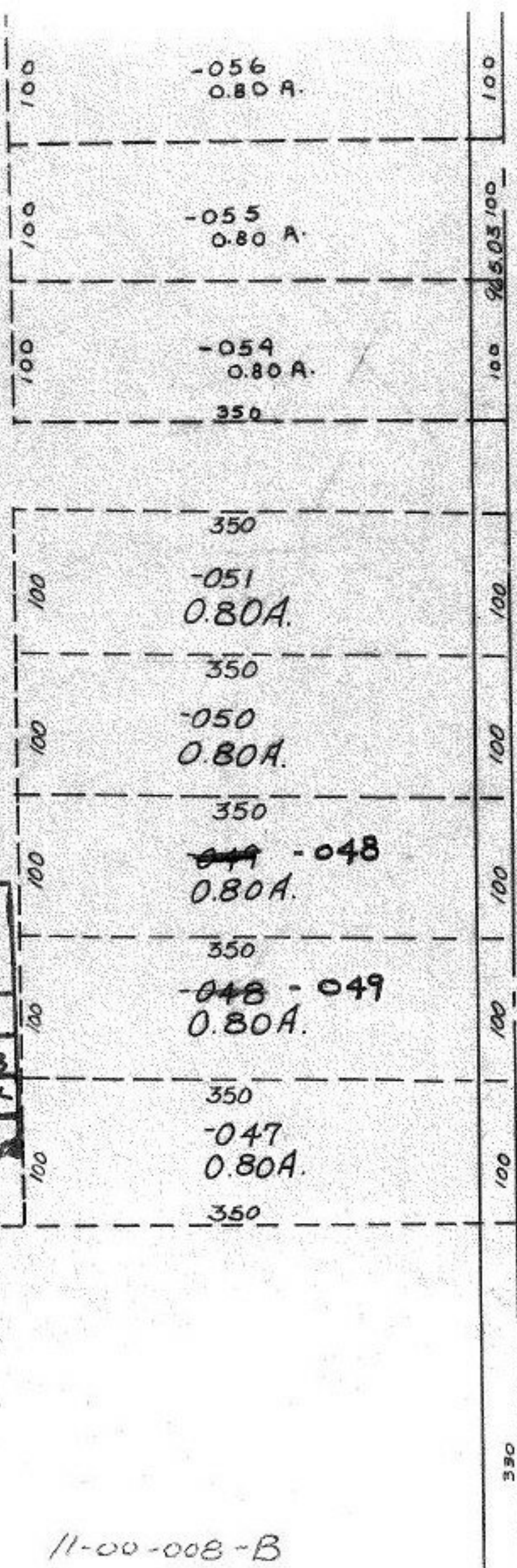

SEE 12-A

11-00-008-B