

POWDERMAKER

145.20 718.28 189.30 148.28

257.25 101.03 101.03 231.50 160 160

* 12172
12173

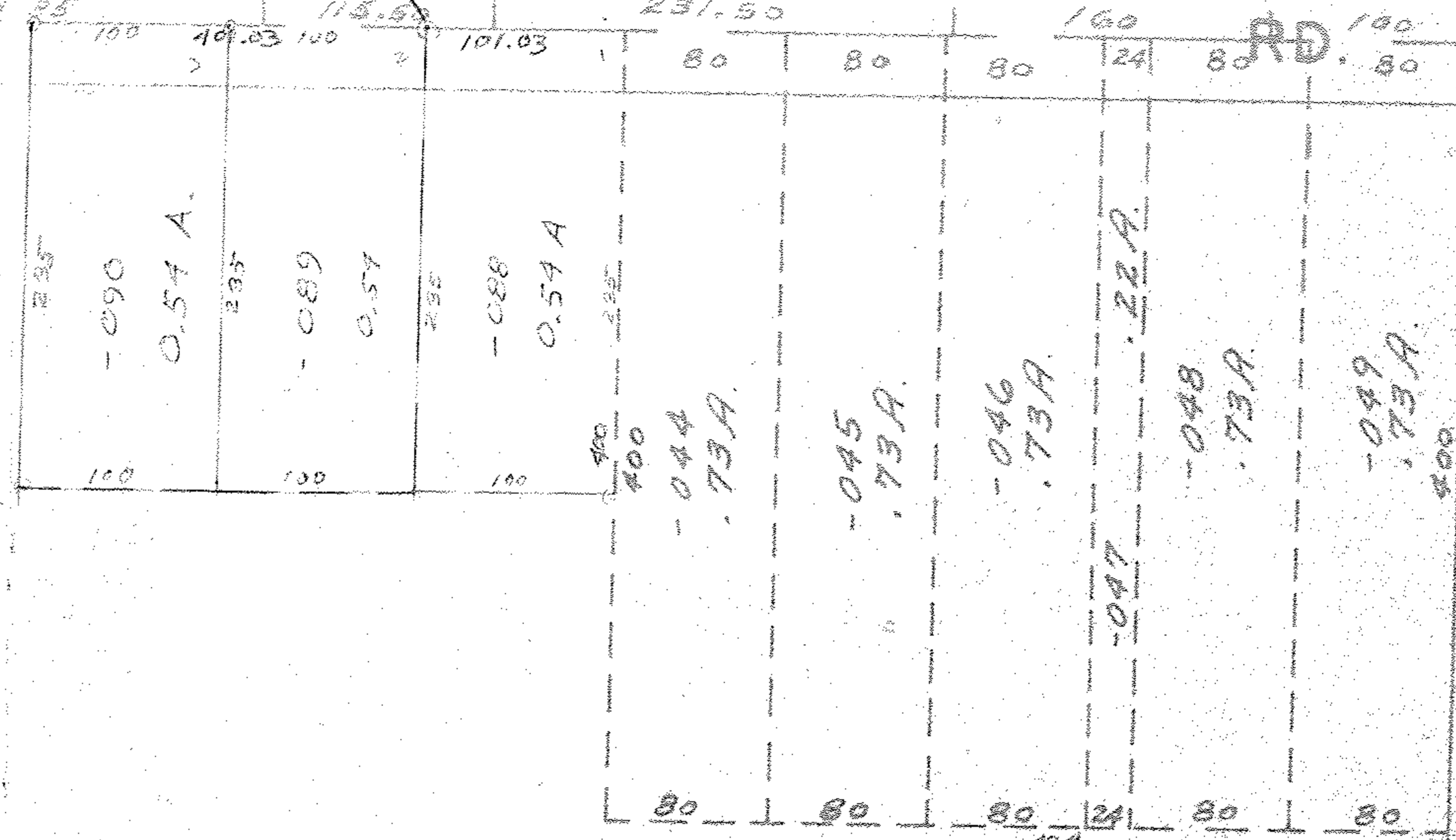

SEE

-087
10.39

-074
21.59 A.

-086 -091
11.20 A 9.58 A

#12173
#12172

APPROVED
LORAIN CO.
MAP DEPT.
DATE 10-25-78
PAGE 4-00-009-14
BY T. McHair
VOID
AFTER

T.M.
1.3.79

363.70
373.16

376.62

423.63
500.03

396
398.83

INTERSTATE

-073
7.82 A.

90

678.97

300.38

297.13

148.30

130

10.60
Stone