

PARENT PARCEL: 11-00-098-000-028

CHILD PARCEL: 11-00-098-000-255, -256

STARTING POINT: NORTHWEST CORNER OF S/L 10 IN C.A. MILLER SUB.(VOL.17 PG.13A)

12-00301

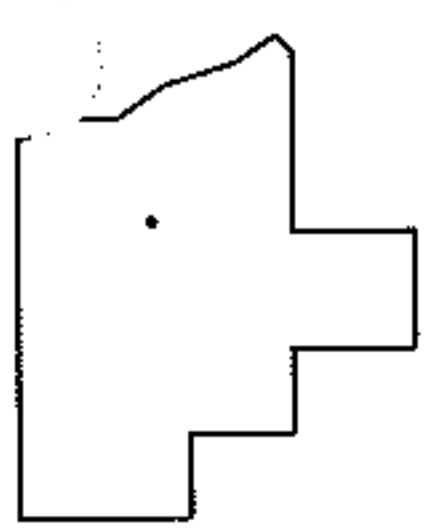
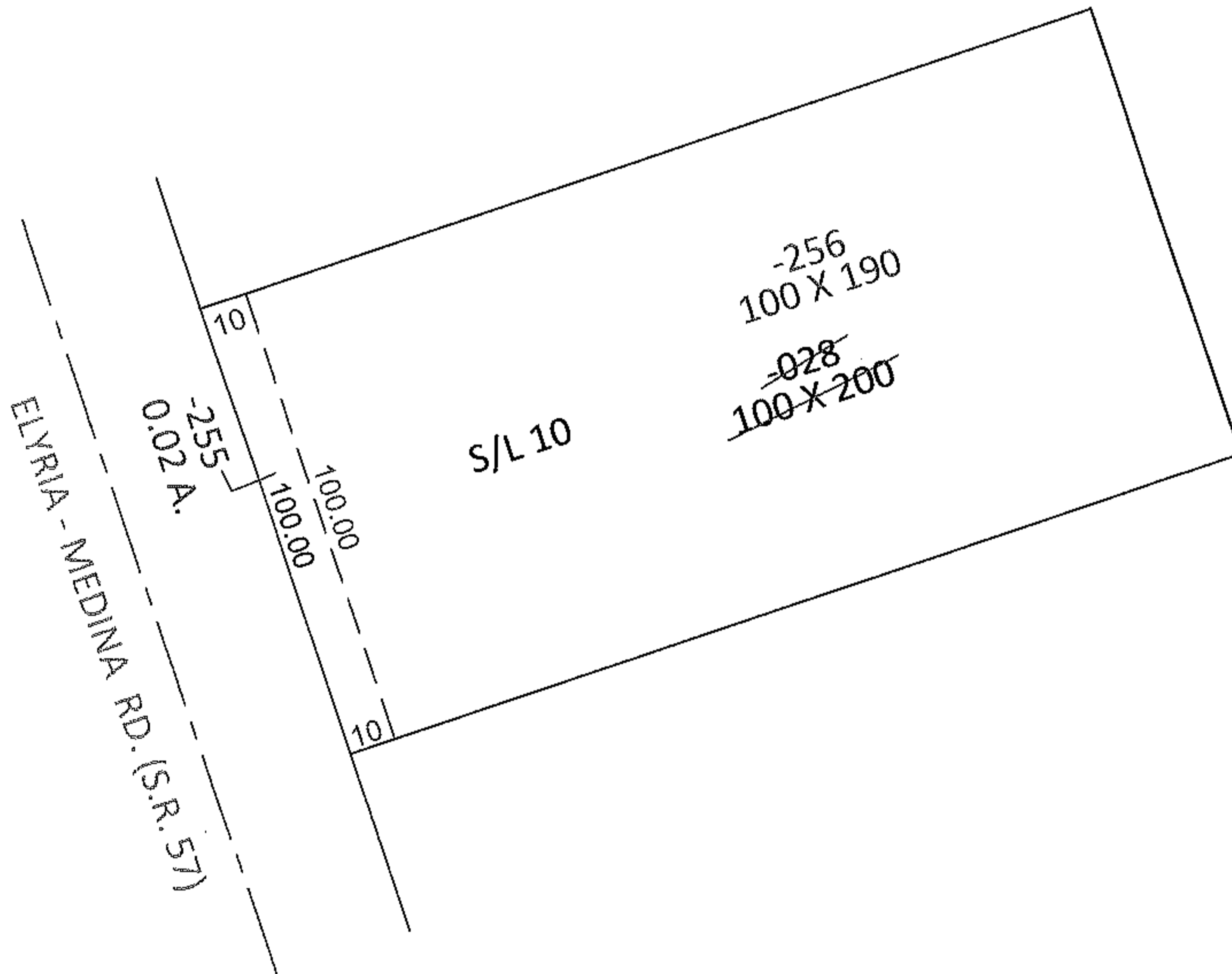
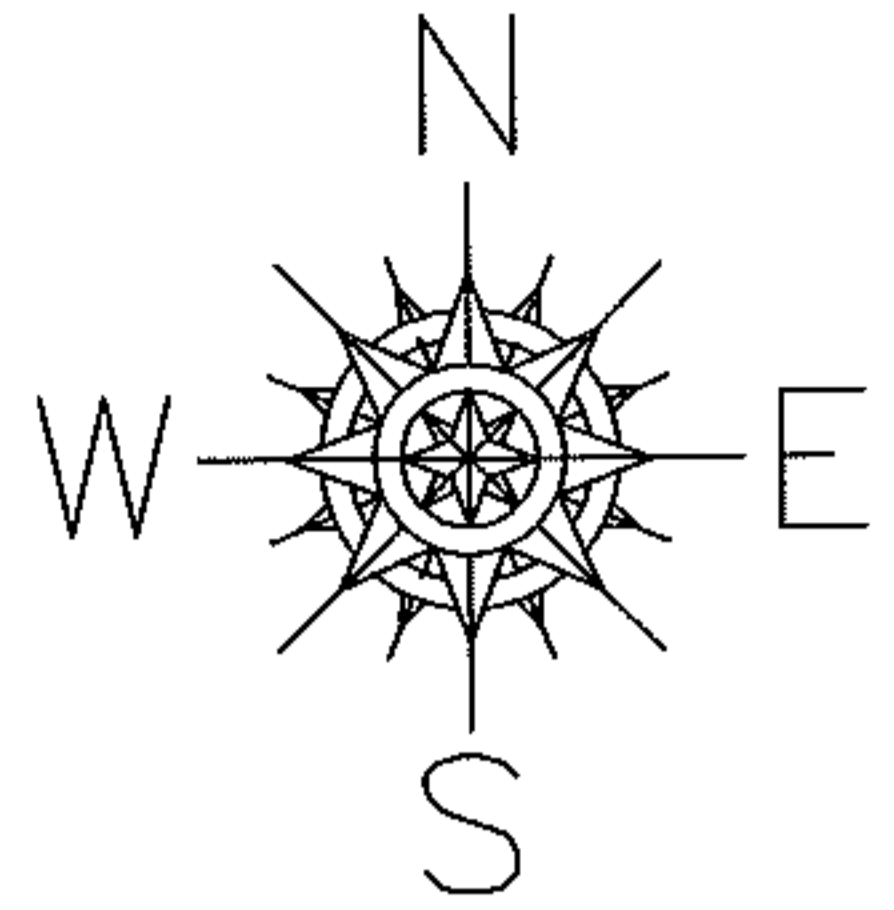

SPLITS/DEEDS PROCESSED

LORAIN COUNTY TAX MAP DEPARTMENT  
226 MIDDLE AVE. ELYRIA, OHIO

SURVEYED BY: KENNETH C. DEAN JR.

CLOSURE: .00:10,000

MAP PAGE(S): 11-00-098-A

APPROVED BY: RRM DATE: 9-20-12

SCALE: 1" = 50' PRIOR INST.: 20080257463