

PARENT PARCEL: 02-02-009-102-010

CHILD PARCEL: 02-02-009-102-040, -041

STARTING POINT: AT A MON BOX AT THE INTERSECTION OF C/L OF JAEGER RD. AND WEST LINE OF TR.2 O.L.9

12-00272

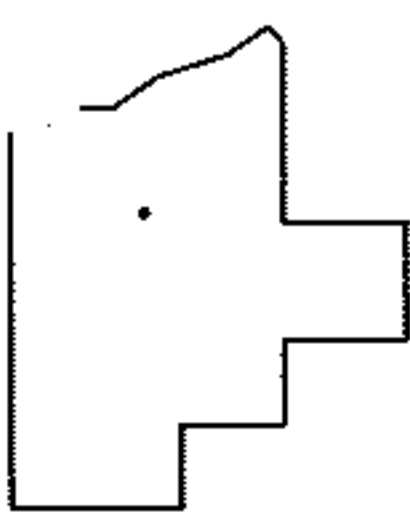
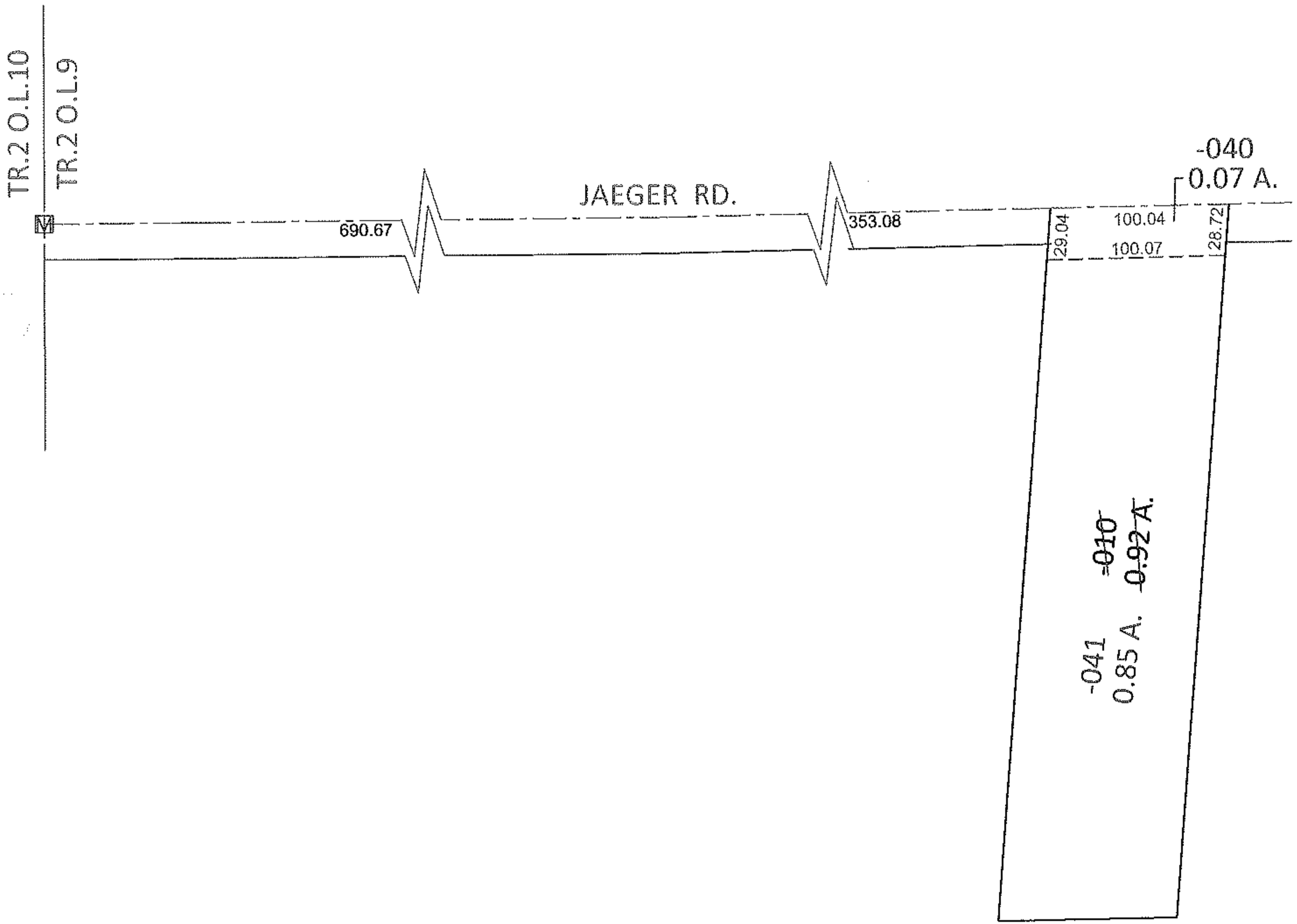
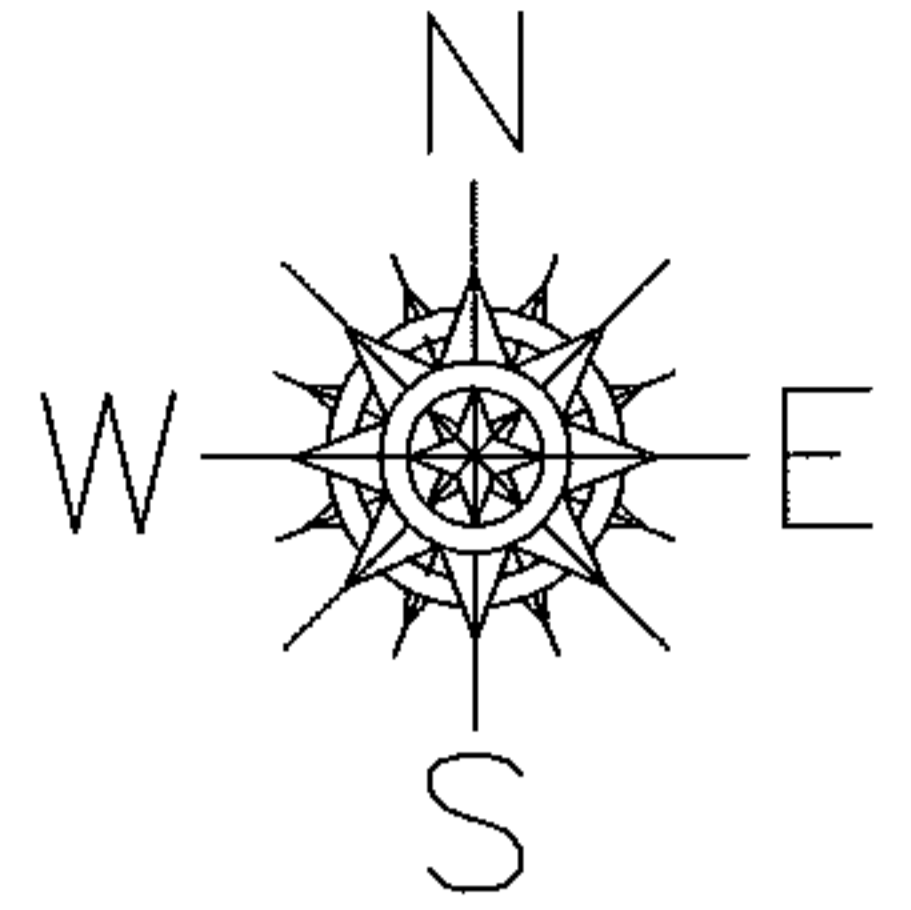

SPLITS/DEEDS PROCESSED

LORAIN COUNTY TAX MAP DEPARTMENT
226 MIDDLE AVE. ELYRIA, OHIO

SURVEYED BY: TREVOR A. BIXLER
 CLOSURE: .00:10,000
 MAP PAGE(S): 2-02-009-A
 APPROVED BY: RRM DATE: 5-2-12
 SCALE: 1"= 100 PRIOR INST.: 20030914216