

10-004-D

297.35
-015 1.00A
1.00A

320

102

Pt. - 019
Pt. 66.584

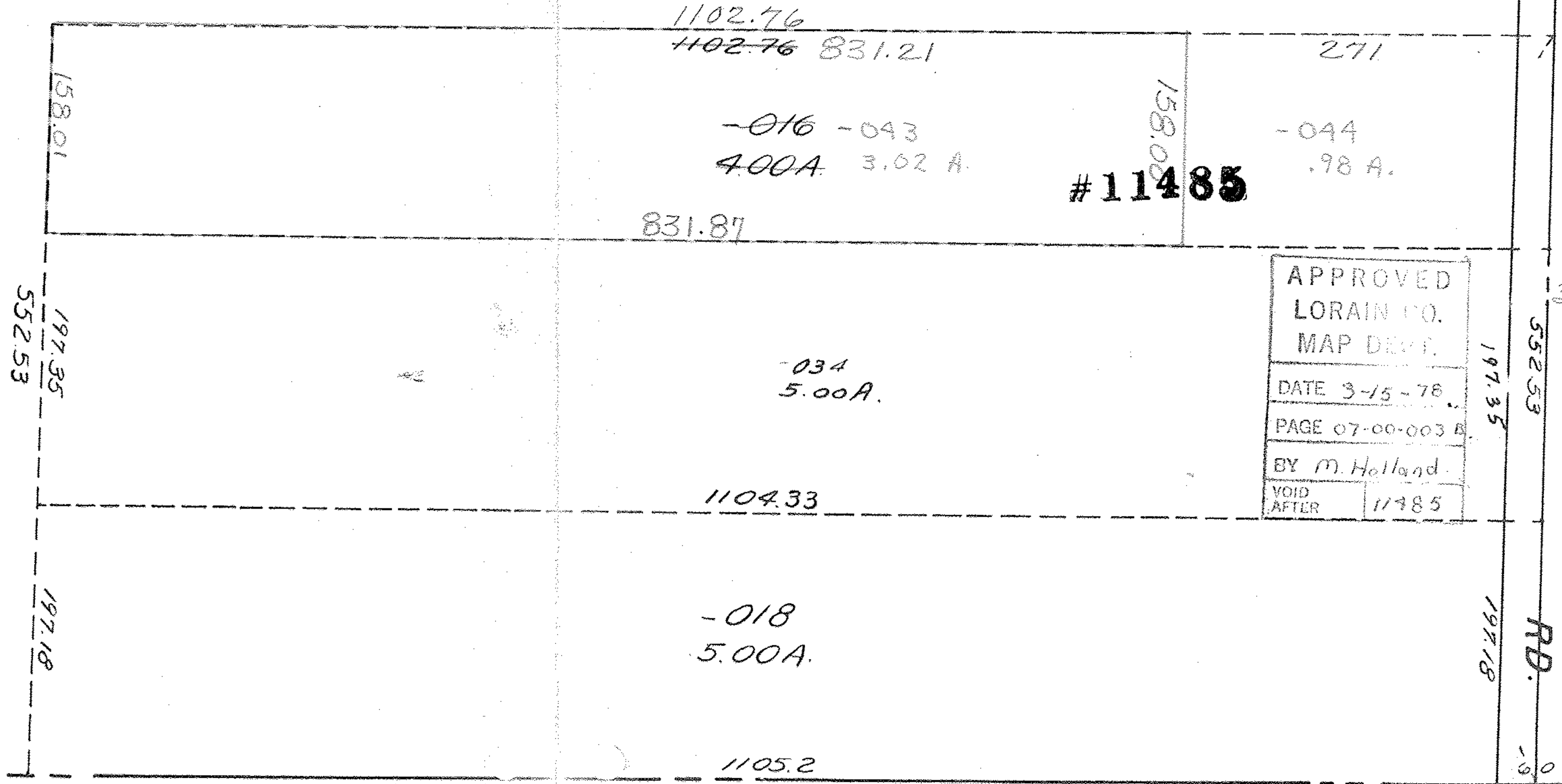

APPROVED
LORAIN CO.
MAP DEPT.
DATE 3-15-78
PAGE 07-00-003 B
BY M. Holland
VOID
AFTER 11485

3/17/78
J.A.

552.53

RD.

197.18

CUYAHOGA CO.

30156
45108

7-15-75 BISK