

303

WAKEMAN-LAGRANGE-RICHFIELD

SEE 14-A

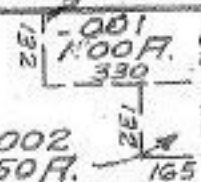

-003
16.50 F.

-002
.50 F.

# 11345	
APPROVED	
LORAIN CO.	
MAP DEPT.	
DATE	1-4-78
PAGE	14-E
BY	Peter R. Beck
VOID AFTER	# 11345

90

-004
101.75 F. 100.45

14-00-090-000-006

-001
81.75 F.

91

101.75
1.30
100.45

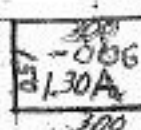

RD



-001
100.50 F.

3300

-002

623.7

(60)