

101280
10-78

83.23

285.38

454.24

271.0

-006
1.85A.

306.70

587.20

-018
4.36A.

~~019~~
~~1.80A.~~

-063
9.02A.

#11280

MS
12-12-77

APPROVED
LORAIN CO.
MAP DEPT.
DATE 12-8-77
PAGE 4-00-D15-1
BY M. S. [Signature]
VOID AFTER 11280

1558.40

109

-020
9.20A.

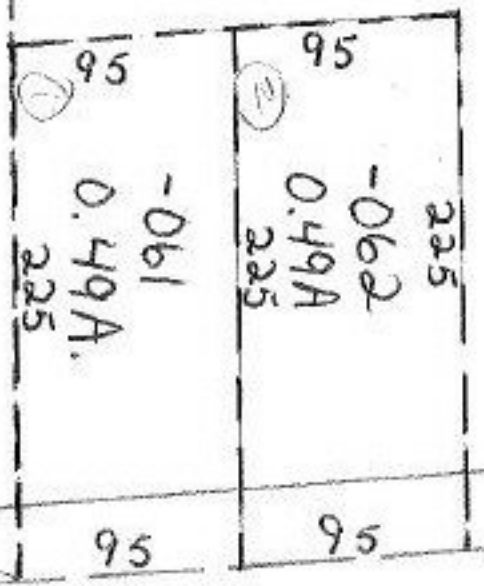
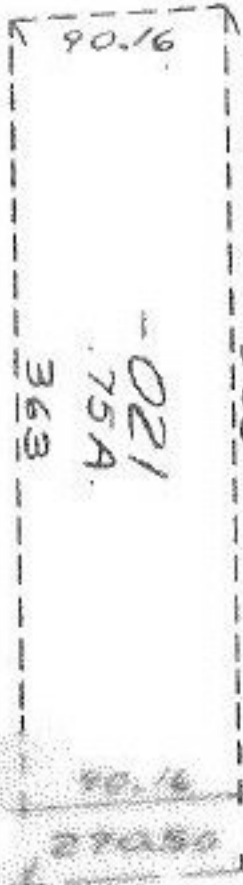

SEE 4-00-015-G