

10-271
8/2/77

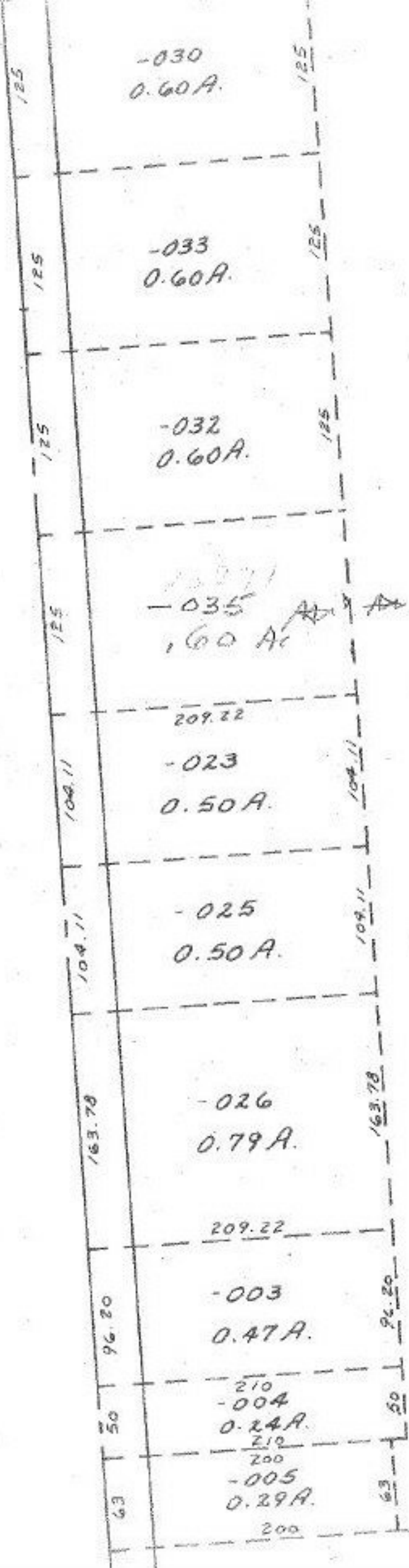

~~PT 034~~
~~PT 69.25 AC~~
 PT 036
 68.65 AC

See 11-00-030/B
 Also

MAR 18 1977

[Signature]

10-271

APPROVED LORAIN CO. MAP DEPT.	
DATE	1/26/77
PAGE	11-00-030 A+B
BY	L. W. Hall
VOID AFTER	3:00 PM

JAN 28 1977

11