

PARENT PARCEL: 09-00-082-000-018

CHILD PARCEL: 09-00-082-000-021, -022

STARTING POINT: CENTERLINE OF QUARRY RD & OBERLIN-NORWALK RD

09-00195

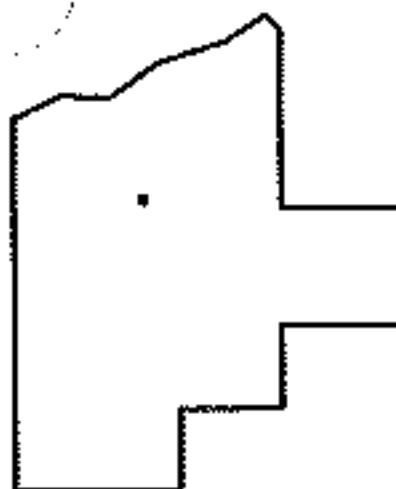
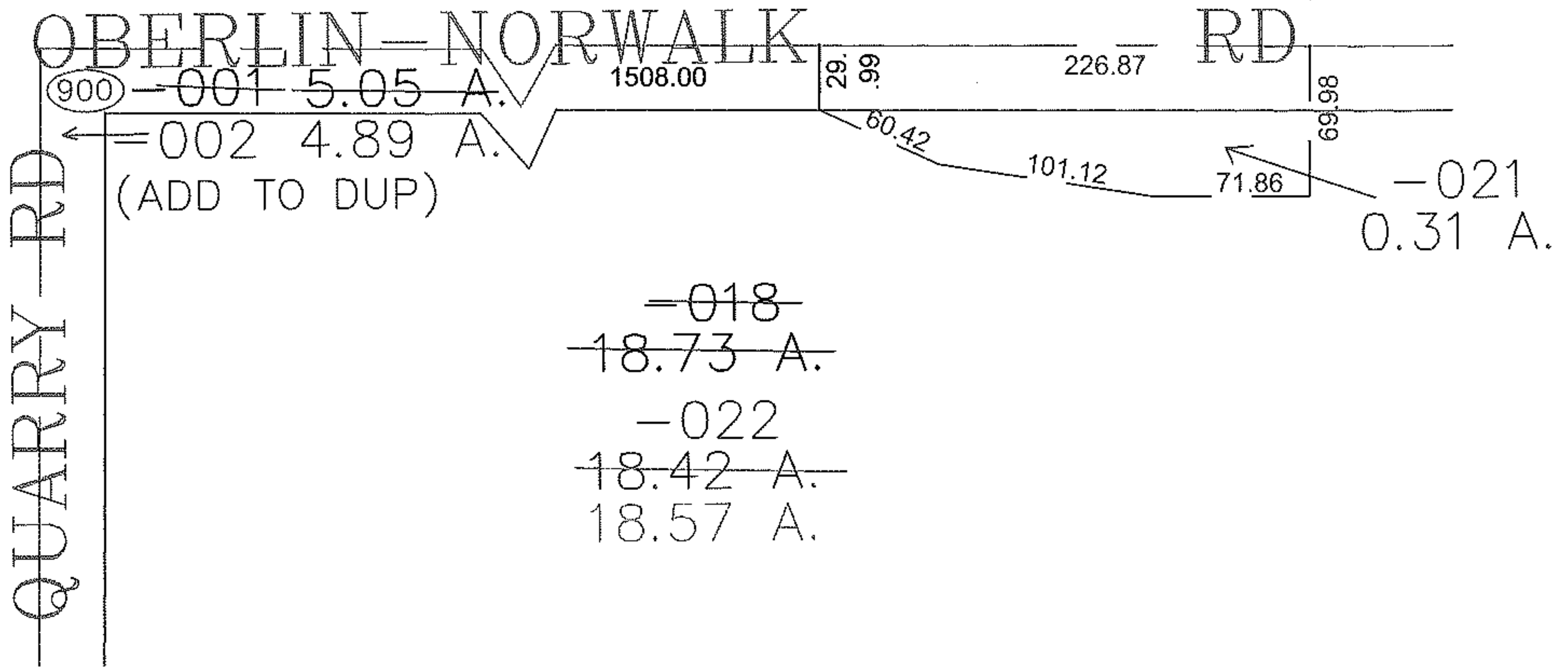
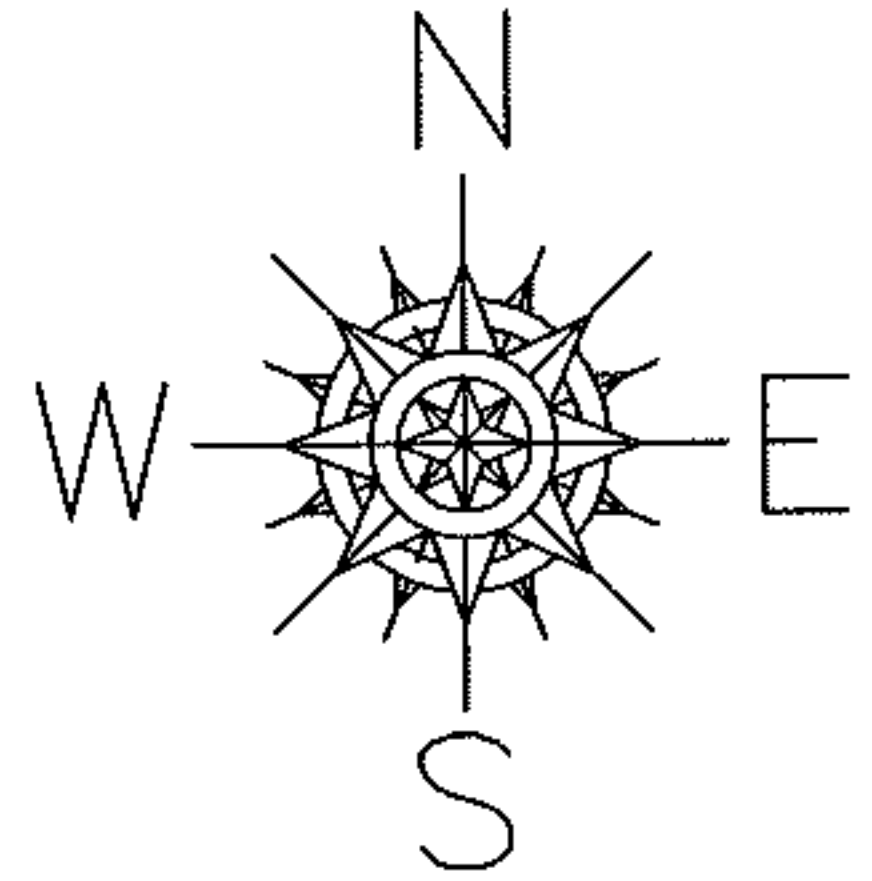

SPLITS/DEEDS PROCESSED

LORAIN COUNTY TAX MAP DEPARTMENT
226 MIDDLE AVE. ELYRIA, OHIO

SURVEYED BY: RAYMOND FOOS

CLOSURE: 0.00 : 10.000

MAP PAGE(S): 09-00-082-A

APPROVED BY: JAH DATE: 11-6-09

SCALE: 1" = 100' PRIOR INSTRUMENT: 20040983220