

PARENT PARCEL: 15-00-016-000-001  
CHILD PARCEL: 15-00-016-000-XXX, -XXX  
STARTING POINT: INT CL S.R. 301 AND NORTH LINE OF O.L. 16

09-00194

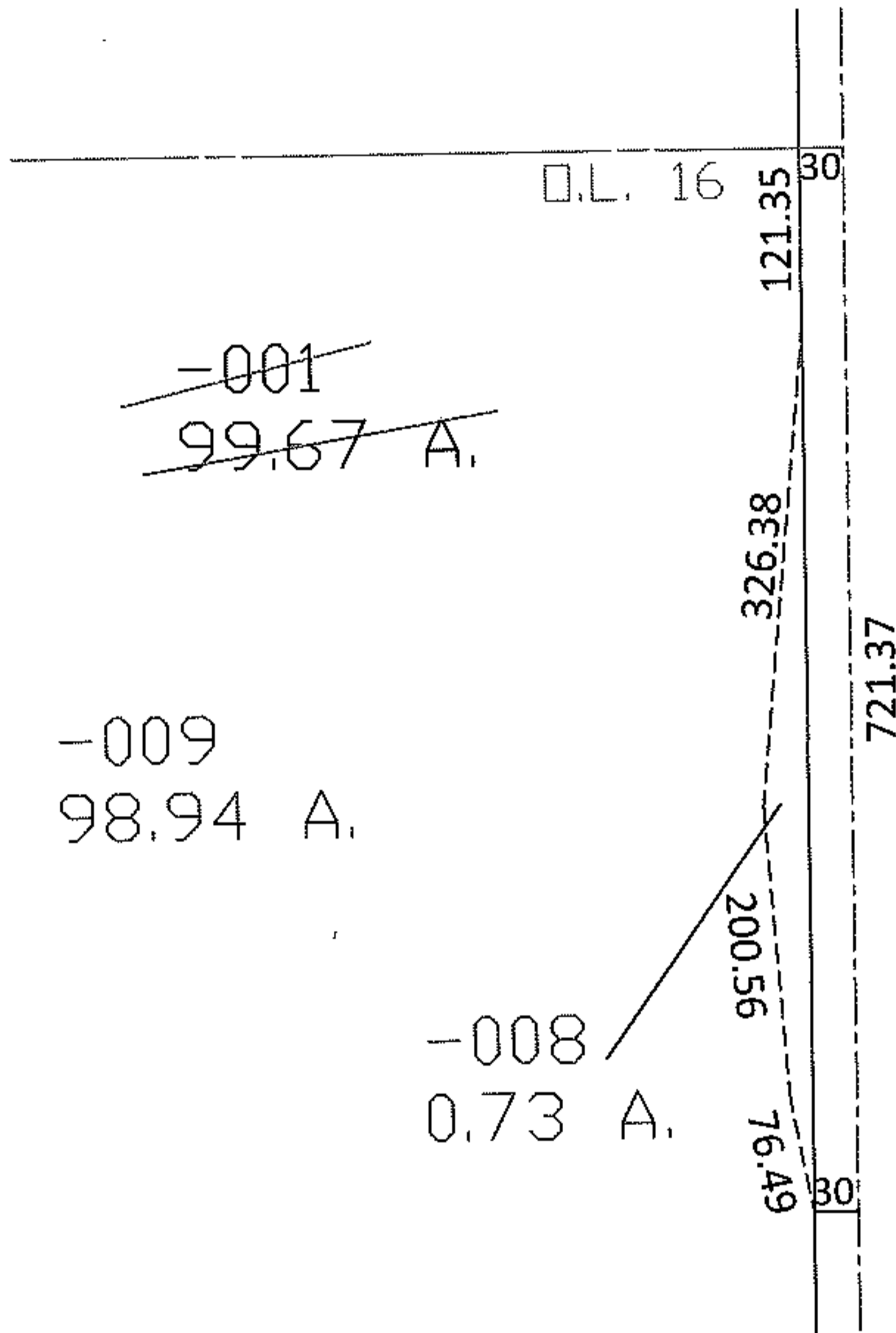
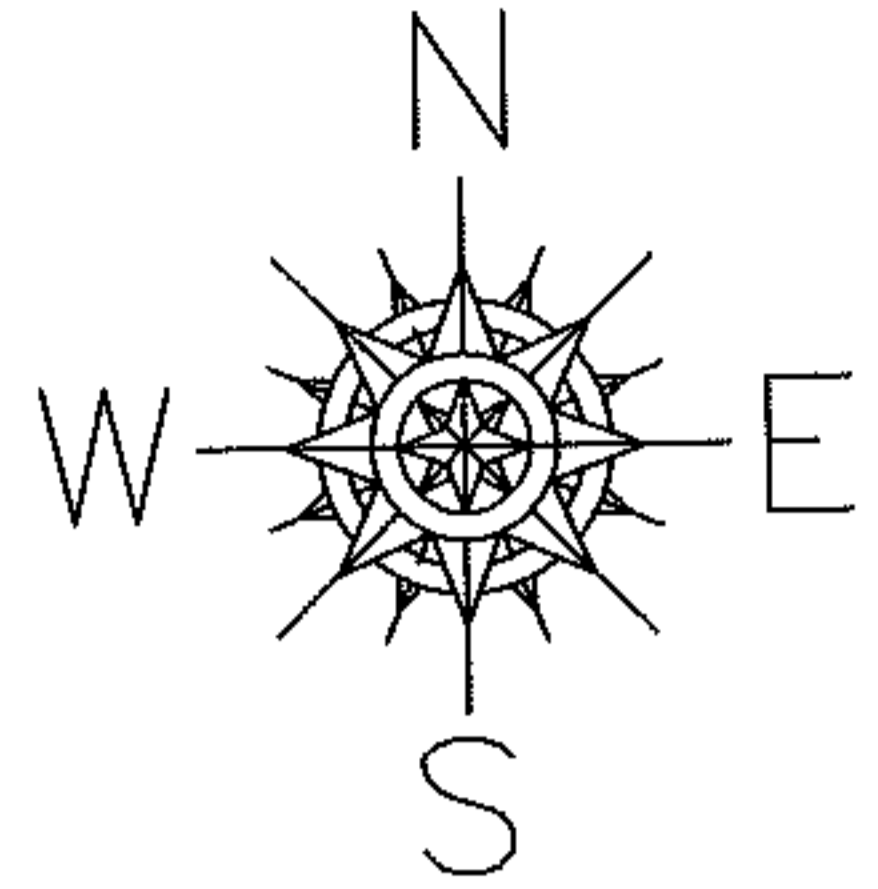

LAGRANGE RD - S.R. 301

PAGE 1 OF 2

**SPLITS/DEEDS PROCESSED**  
LORAIN COUNTY TAX MAP DEPARTMENT  
226 MIDDLE AVE. ELYRIA, OHIO

SURVEYED BY: SHANE L. QUEER  
CLOSURE: 1:10,000  
MAP PAGE(S): 15-B, 15-C  
APPROVED BY: DRH DATE: 2/25/2009  
SCALE: 1" = 200' PRIOR INSTRUMENT: 19940292200