

15-00-046-104-021

FR & DPTH TO AC CORR PER SURVEYOR STEPHEN CAMPBELL

INTERSECTION OF C/LS OF LIBERTY ST & N. CENTER ST

25-05630-C

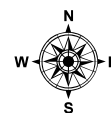

86.37

12

98.23

196.60

79.60

-024

09.67

-025

79.60

-002

09.67

86.37

160 ၁၆၀



64.01

-021

.24

64.06

64.05

160

29.26

64.06

64.07

9.
.80

64.69

-023

1

.35

99.80

84.70

52

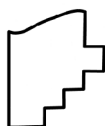

SPLITS/DEEDS PROCESSED

LORAIN COUNTY TAX MAP DEPARTMENT
226 MIDDLE AVE. ELYRIA, OH

SURVEYED BY: STEPHEN CAMPBELL

SURVEY # 51610

CLOSURE: 1: 161872

MAP PAGE(S): 15-00-046

APPROVED BY: WRZ **DATE:** 11/26/2025

SCALE: 1" = 25' **PRIOR INSTRUMENT:** #2016-0595942