

25-05477-C

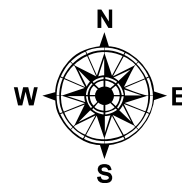

50

31.11

46.04

66

31

46.18

72-045

71-046

153.01

047

153.01

-048

145

351

12

34

950-

50

45

47.48

16

30.
.48

31

31

34

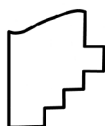

SPLITS/DEEDS PROCESSED
LORAIN COUNTY TAX MAP DEPARTMENT
226 MIDDLE AVE. ELYRIA, OH

SURVEYED BY: KEITH A. STEPHENSON

SURV # 51417

CLOSURE: 1: INF

MAP PAGE(S): 02-01-006

APPROVED BY: AC **DATE:** March 31, 2025

SCALE: 1 in = 25 ft **PRIOR INSTRUMENT:** 2020- 0790047