

PARENT PARCEL: 01-00-028-101-023

CHILD PARCEL: MAP CORR.PER SURVEY ROBER RUFFING

STARTING POINT: C/L OF CLAUS RD. & JERUSALEM RD.

25-05434-C

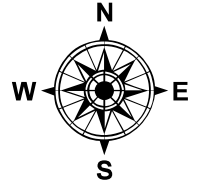

21

1.63

314

64.67

~~260.53~~

260.11

-023

1.65

155.28

CLAUS

157

124.30

~~124.28~~

15.65

213.72

~~213.75~~

RD.

45

301.01

27.03

171.48

267.60

2

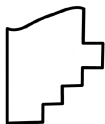

**SPLITS/DEEDS PROCESSED**

LORAIN COUNTY TAX MAP DEPARTMENT  
226 MIDDLE AVE. ELYRIA, OH

SURVEYED BY: ROBERT RUFFING

SURVEY #: 51357

CLOSURE: 1:66561

MAP PAGE(S): 01-00-028

APPROVED BY: DMA DATE: 1/2/2025

SCALE: 1" = 50'

PRIOR INSTRUMENT: 2015-0533674