

PARENT PARCEL: 12-00-005-101-018 & -019

CHILD PARCEL: 12-00-005-101-032

COMBO PER PRIOR INSTR. #2018-0660086

23-05203-C

STARTING POINT:

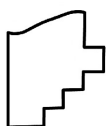
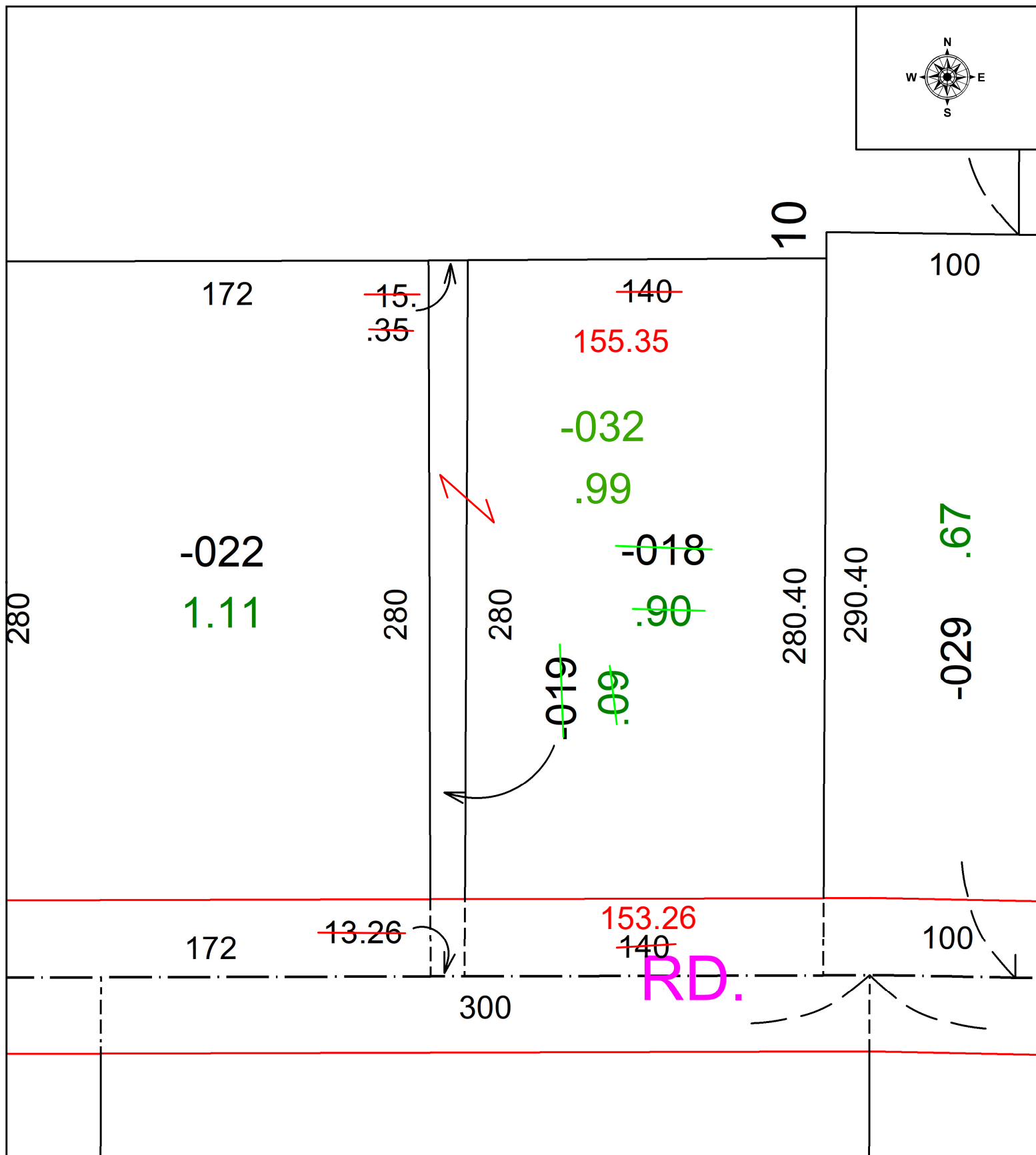
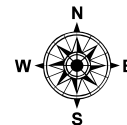

**SPLITS/DEEDS PROCESSED**  
 LORAIN COUNTY TAX MAP DEPARTMENT  
 226 MIDDLE AVE. ELYRIA, OH

SURVEYED BY: RAY HOLLIS SURVEY # N/A  
 CLOSURE: 1:  
 MAP PAGE(S): 12-00-005  
 APPROVED BY: WRZ DATE: 12/4/2023  
 SCALE: 1" = 50 PRIOR INSTRUMENT: #2018-0660086