

PARENT PARCEL: 12-00-036-000-021

CHILD PARCEL: 12-00-036-000-053, -054

STARTING POINT: INTERSECTION OF C/L OF S.R. 82 AND SOUTHWEST CORNER OF O.L.36

NO. 00144

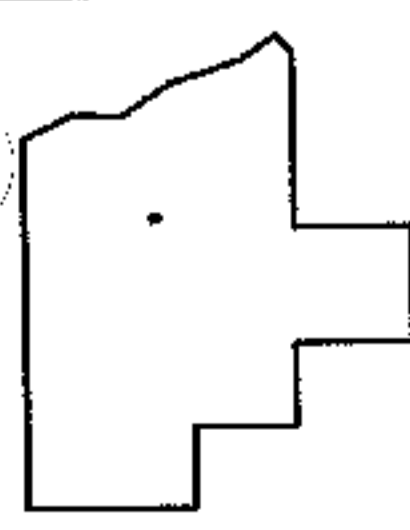
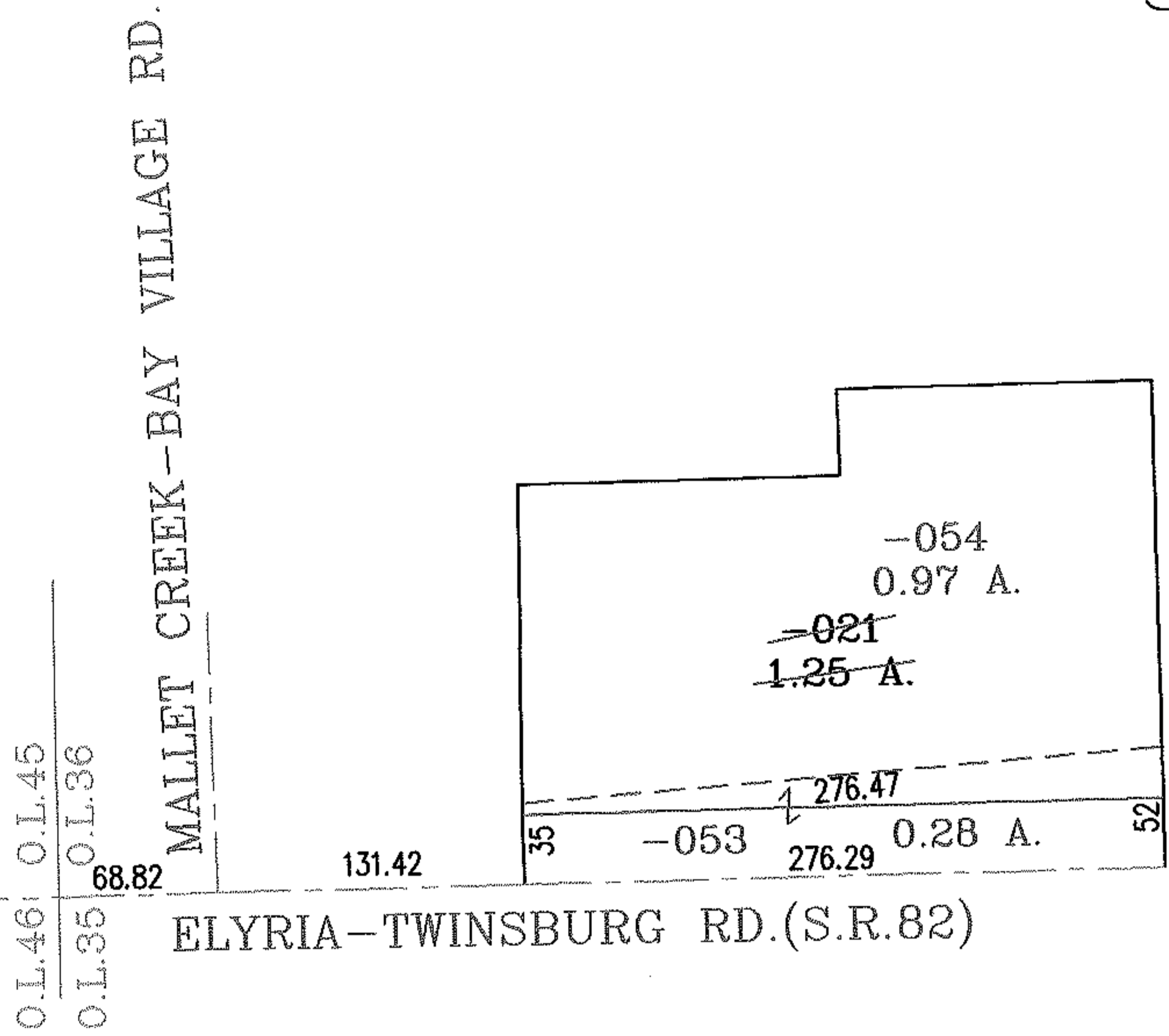
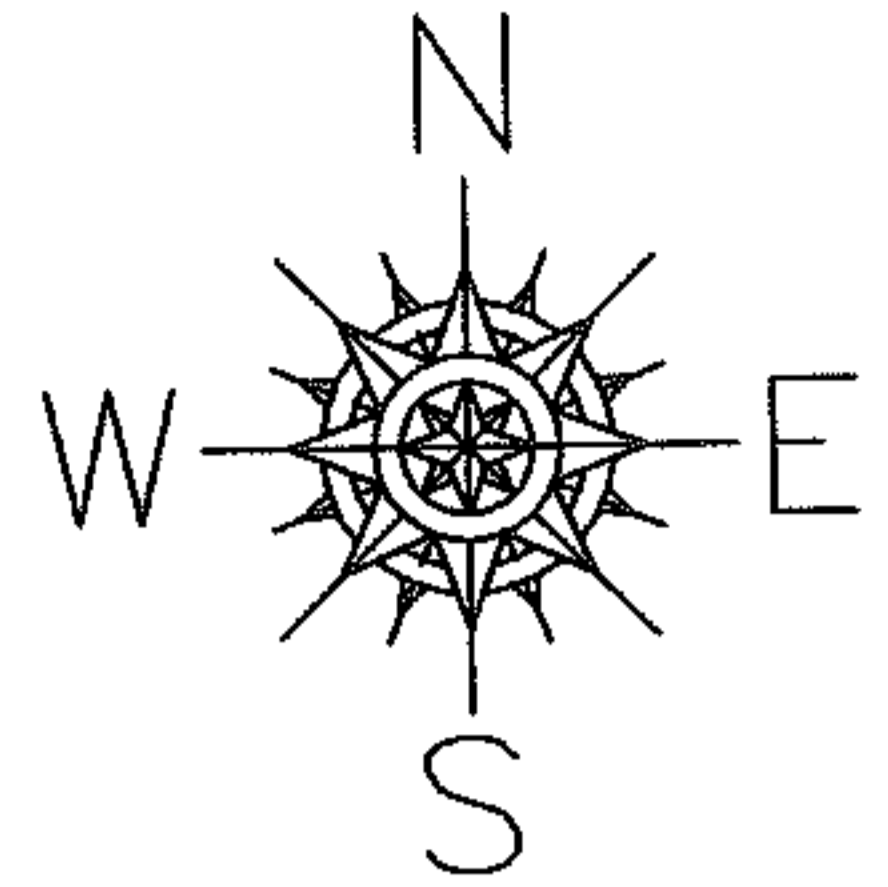

SPLITS/DEEDS PROCESSED

LORAIN COUNTY TAX MAP DEPARTMENT
 226 MIDDLE AVE. ELYRIA, OHIO

SURVEYED BY: MARK ALLEN YEAGER

CLOSURE: .01:10.000

MAP PAGE(S): 12-00-036-A

APPROVED BY: JH/RM DATE: 3-8-05

SCALE: 1" = 100' PRIOR INSTRUMENT: DV 1425/64