

PARENT PARCEL: 02-01-006-152-023

CHILD PARCEL: DEPTH CORR. PER VAC. ORD. # 5287

STARTING POINT: N/A

22--04805-C

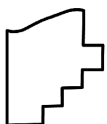
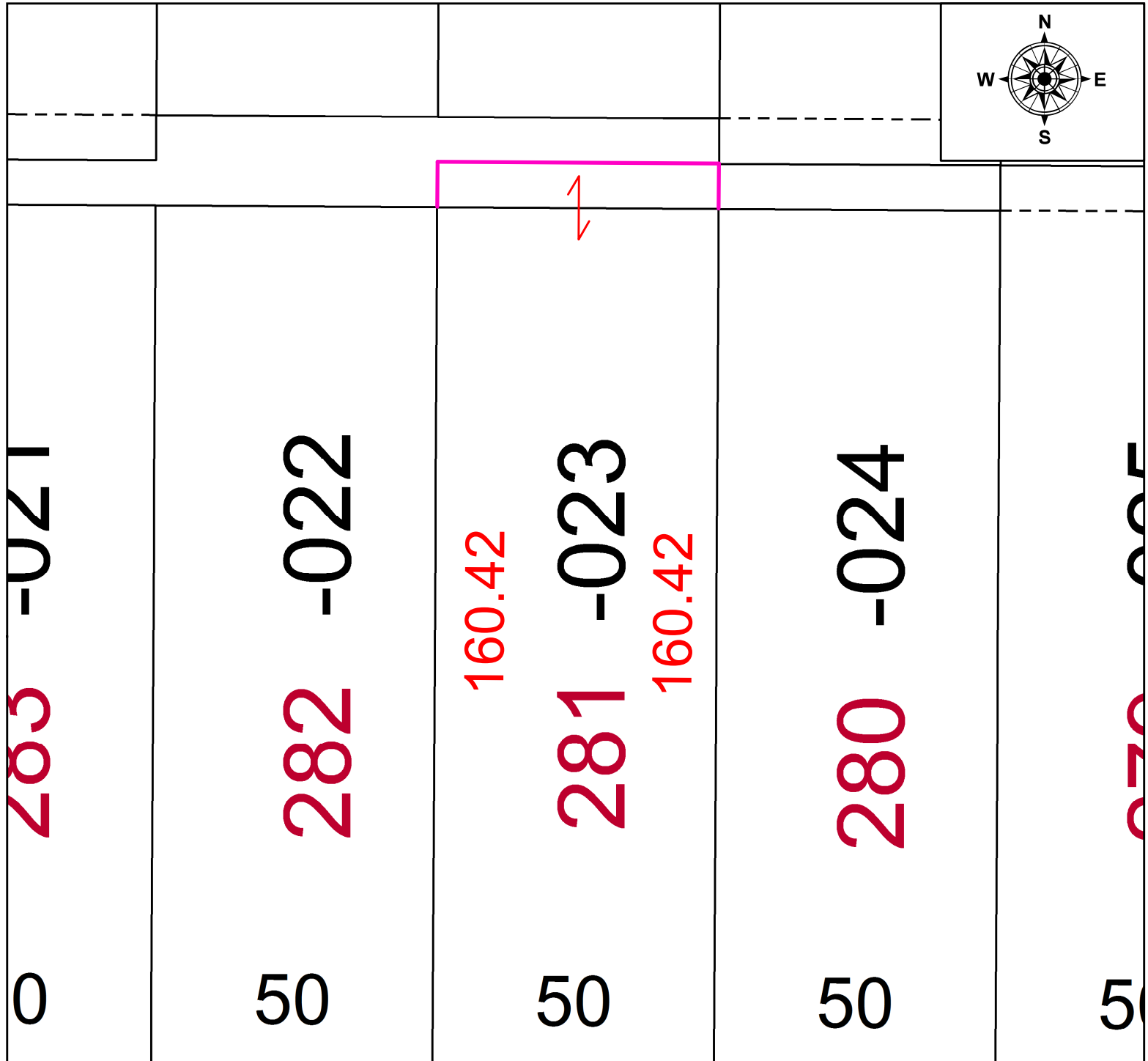
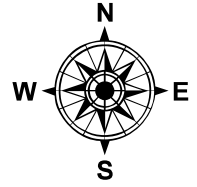

SPLITS/DEEDS PROCESSED
 LORAIN COUNTY TAX MAP DEPARTMENT
 226 MIDDLE AVE. ELYRIA, OH

SURVEYED BY: N/A
 CLOSURE: N/A
 MAP PAGE(S): 02-01-006
 APPROVED BY: DMA DATE: 3/8/2022
 SCALE: 1" = 25' PRIOR INSTRUMENT: 2018-0340565