

PARENT PARCEL: 07-00-033-114-028 DEPTH CORR. FROM 120.54 X 148.86 TO 120.54 X 152.86

CORRECTION: CERTIFICATE OF CORRECTION

STARTING POINT: CERT. OF CORR. ON S/L 1493

20-04321-C

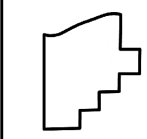
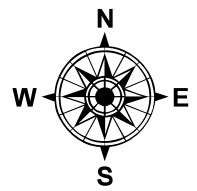

SPLITS/DEEDS PROCESSED
 LORAIN COUNTY TAX MAP DEPARTMENT
 226 MIDDLE AVE. ELYRIA, OH

SURVEYED BY: ALEX MARKS
 CLOSURE: NA
 MAP PAGE(S): 07-00-033
 APPROVED BY: TJS DATE: 4/27/2020
 SCALE: 1" = 30' PRIOR INSTRUMENT: PV 106/68